

THIS MAP SHOWS THE BOUNDARIES OF AREAS TO BE ANNEXED TO COMMUNITY FACILITIES DISTRICT NO. 2015-2 (MAINTENANCE SERVICES), OF THE CITY OF LAKE ELSINORE, COUNTY OF RIVERSIDE, STATE OF CALIFORNIA.

THE BOUNDARIES OF WHICH COMMUNITY FACILITIES DISTRICT ARE SHOWN AND DESCRIBED ON THE MAP THEREOF WHICH WAS PREVIOUSLY RECORDED ON AUGUST 13, 2015 IN BOOK 78 OF MAPS OF ASSESSMENT AND COMMUNITY FACILITIES DISTRICT AT PAGE 73 AND AS INSTRUMENT NO. 2015-0361493 IN THE OFFICE OF THE COUNTY RECORDER OF THE COUNTY OF RIVERSIDE, STATE OF CALIFORNIA.

I HEREBY CERTIFY THAT THE WITHIN MAP SHOWING PROPOSED BOUNDARIES TO BE ANNEXED TO COMMUNITY FACILITIES DISTRICT NO. 2015-2 (MAINTENANCE SERVICES), CITY OF LAKE ELSINORE, COUNTY OF RIVERSIDE, STATE OF CALIFORNIA, WAS APPROVED BY THE CITY COUNCIL OF THE CITY OF LAKE ELSINORE AT A REGULAR MEETING THEREOF, HELD ON 8th DAY OF December, 2020, BY RESOLUTION NO. 2020-98.

CITY CLERK
CITY OF LAKE ELSINORE

FILED IN THE OFFICE OF THE CITY CLERK, CITY OF LAKE ELSINORE THIS 9th DAY OF December, 2020.

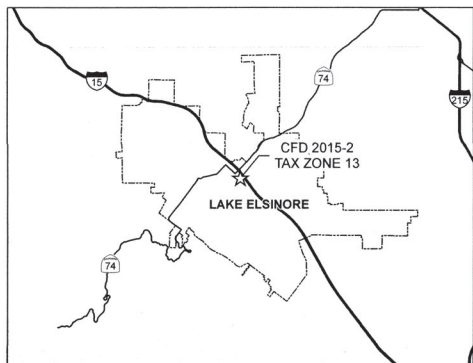

CITY CLERK
CITY OF LAKE ELSINORE



THIS ANNEXATION MAP CORRECTLY SHOWS THE LOT OR PARCEL OF LAND INCLUDED WITHIN THE BOUNDARIES OF THE COMMUNITY FACILITIES DISTRICT. FOR DETAILS CONCERNING THE LINES AND DIMENSIONS OF LOTS OR PARCEL REFER TO THE COUNTY ASSESSOR MAPS FOR FISCAL YEAR 2020-21.

ANNEXATION MAP NO. 11

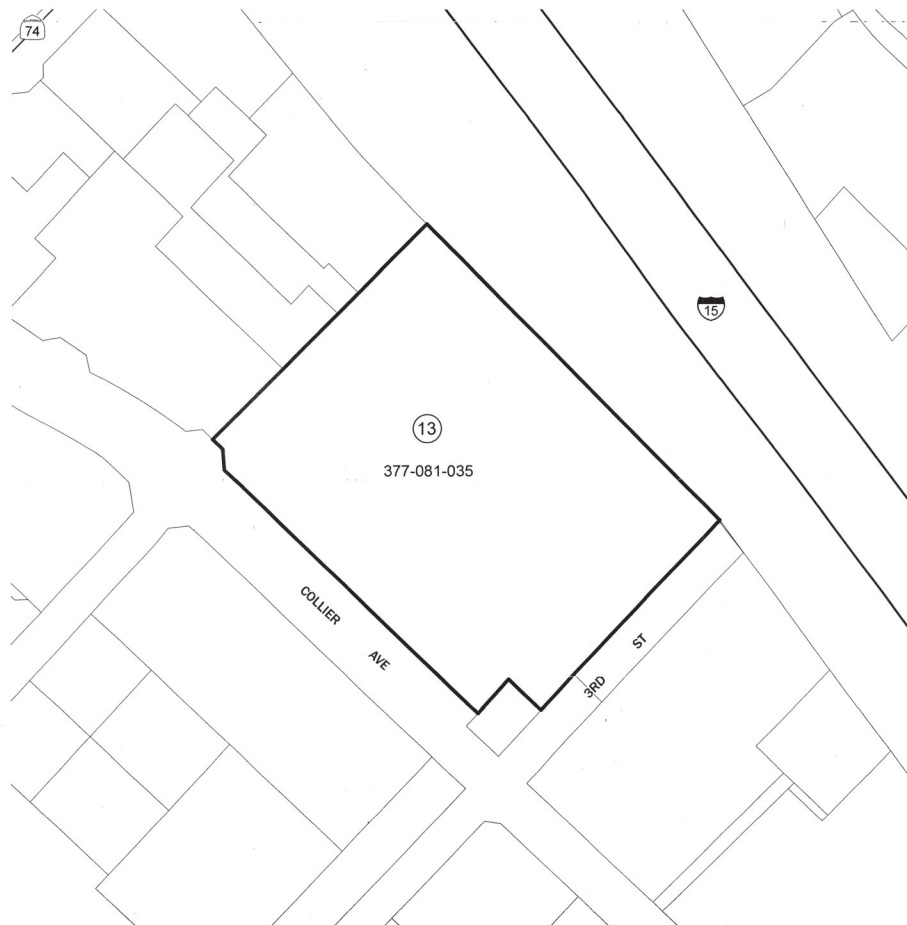
COMMUNITY FACILITIES DISTRICT NO. 2015-2 (MAINTENANCE SERVICES) CITY OF LAKE ELSINORE, COUNTY OF RIVERSIDE, STATE OF CALIFORNIA





RECORDED THIS 23 DAY OF December, 2020 AT THE HOUR OF 1:20 O'CLOCK P M IN BOOK 86 PAGE 19 OF MAPS OF ASSESSMENT AND COMMUNITY FACILITIES DISTRICTS IN THE OFFICE OF THE COUNTY RECORDER, IN THE COUNTY OF RIVERSIDE, STATE OF CALIFORNIA.

FEE: 49⁰⁰ NO.: 2020-0655512
PETER ALDANA, ASSESSOR; COUNTY CLERK, RECORDER

BY: 
DEPUTY

LEGEND

-  ANNEXATION AREA BOUNDARY
-  PARCEL LINE
- XXX-XXX-XXX ASSESSOR PARCEL NUMBER
-  TAX ZONE

