

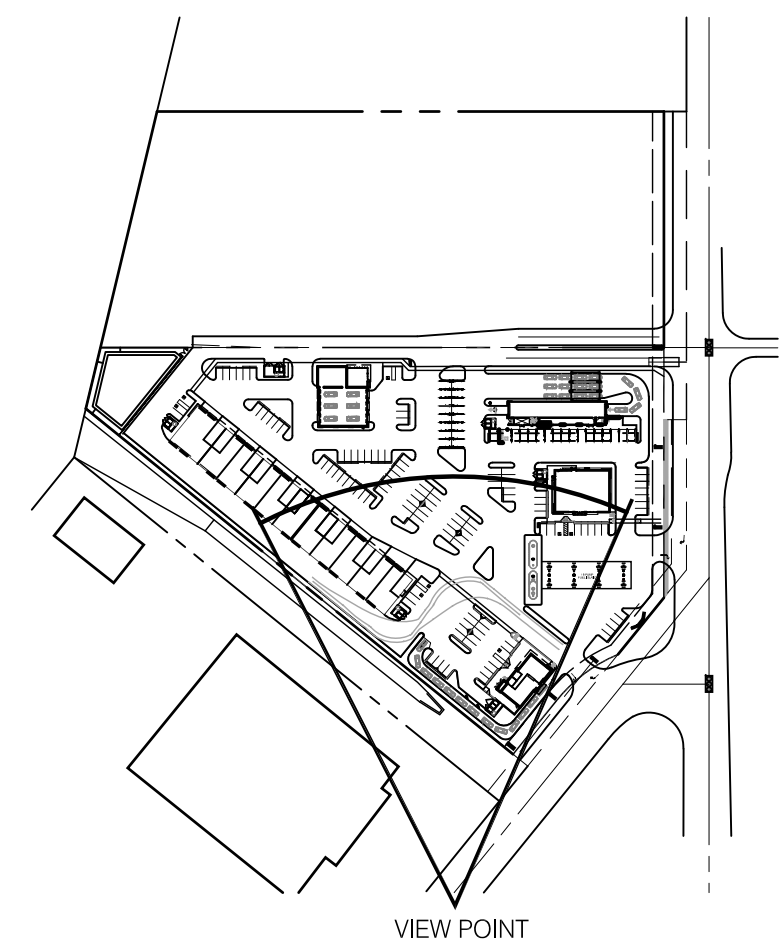

STREET VIEW FROM CORYDON ROAD- LOOKING NORTH



NOTE:  
BUILDING AREAS AND LAND COVERAGE ARE PRELIMINARY AND  
SUBJECT TO ADJUSTMENT. ANY PROPOSED DEVELOPMENT IS  
SUBJECT TO APPROVAL OF GOVERNMENT OR OTHER  
AGENCIES HAVING JURISDICTION. ALL DIMENSIONS AND SITE  
CONDITIONS ARE SUBJECT TO VERIFICATION.

STREET VIEW

CORYDON GATEWAY  
LAKE ELSINORE, CA

GKPA PROJECT #19114.01  
7 MAY 2020

**CORYDON GATEWAY**  
LAKE ELSINORE, CALIFORNIA

**RED CORYDON, LLC**  
25425 JEFFERSON AVENUE, SUITE 101  
MURRIETA, CA 92562  
951.643.4711

**GK PIERCE**  
ARCHITECTS  
3 OVERTURE  
ALISO VIEJO, CA 92656  
T 949.344.2710  
F 949.344.2720  
©GK PIERCE ARCHITECTS, INC. 2020





STREET VIEW FROM CORYDON/ MISSION TRAIL INTERSECTION- LOOKING NORTHWEST

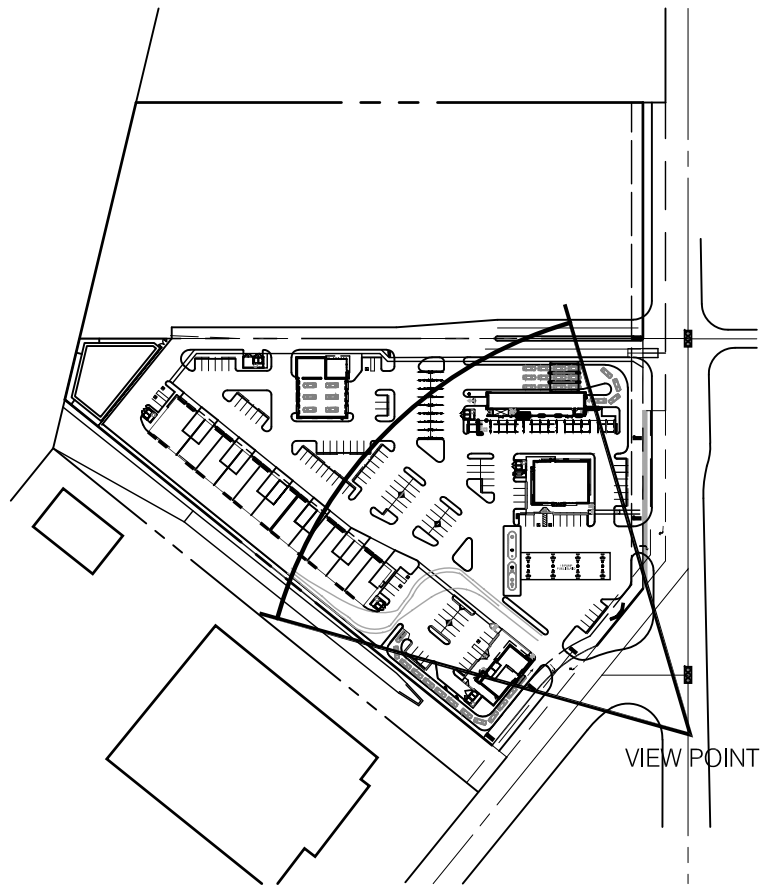

NOTE:  
BUILDING AREAS AND LAND COVERAGE ARE PRELIMINARY AND  
SUBJECT TO ADJUSTMENT. ANY PROPOSED DEVELOPMENT IS  
SUBJECT TO APPROVAL OF GOVERNMENT OR OTHER  
AGENCIES HAVING JURISDICTION. ALL DIMENSIONS AND SITE  
CONDITIONS ARE SUBJECT TO VERIFICATION.

STREET VIEW

CORYDON GATEWAY  
LAKE ELSINORE, CA  
GKPA PROJECT #19114.01  
7 MAY 2020

CORYDON GATEWAY  
LAKE ELSINORE, CALIFORNIA

RED CORYDON, LLC  
25425 JEFFERSON AVENUE, SUITE 101  
MURRIETA, CA 92562  
951.643.4711

GK

P

PIERCE  
ARCHITECTS  
3 OVERTURE  
ALISO VIEJO, CA 92656  
T 949.344.2710  
F 949.344.2720

©GK PIERCE ARCHITECTS, INC. 2020





STREET VIEW FROM MISSION TRAIL/ LEMON INTERSECTION- LOOKING SOUTHWEST

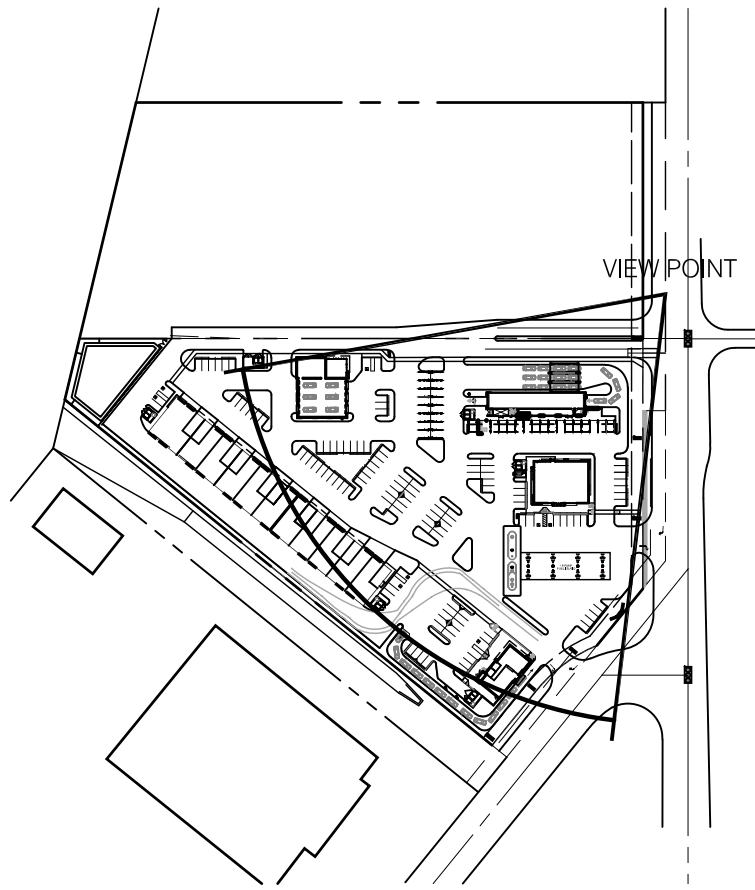

NOTE:  
BUILDING AREAS AND LAND COVERAGE ARE PRELIMINARY AND  
SUBJECT TO ADJUSTMENT. ANY PROPOSED DEVELOPMENT IS  
SUBJECT TO APPROVAL OF GOVERNMENT OR OTHER  
AGENCIES HAVING JURISDICTION. ALL DIMENSIONS AND SITE  
CONDITIONS ARE SUBJECT TO VERIFICATION.

STREET VIEW

CORYDON GATEWAY  
LAKE ELSINORE, CA  
GKPA PROJECT #19114.01  
7 MAY 2020

CORYDON GATEWAY  
LAKE ELSINORE, CALIFORNIA

RED CORYDON, LLC  
25425 JEFFERSON AVENUE, SUITE 101  
MURRIETA, CA 92562  
951.643.4711

GK

P

GK

PIERCE

ARCHITECTS

3 OVERTURE

ALISO VIEJO, CA 92656

T 949.344.2710

F 949.344.2720

©GK PIERCE ARCHITECTS, INC. 2020