

NOTES:

Planning Division Notes:

1. Must screen trailers from all public right of ways, preferably in the form of potted plants.
2. No loitering signs must be posted and trailers must be fully staffed during all operating hours.
3. Must remove any graffiti within twenty-four (24) hours.

STORM WATER MANAGEMENT / POLLUTION PREVENTION / NPDES:

Project shall have a minimum of four (4) trash cans onsite; two (2) for general trash and two (2) for non-CRV recyclables. Trash cans shall have lids to limit discharge.

Two wet bins shall be provided for dumping of liquids from containers. The wet bins shall be dumped in the sanitary sewer daily.

Project shall have a spill kit onsite.

Project shall use dry clean-up methods and/or a mop and bucket for daily cleanup. Disposal of mop water shall be to sanitary sewer.

The project shall power wash the site twice a month; BMPs shall be deployed to capture water used in the power washing activity.

Project is responsible for ensuring that pollutants from the site do not enter the storm drain system. City Municipal Code 14.08 defines "Pollutant" as:

Fire:

Obtain one (1) fire extinguisher with a 2A-10BC rating per site.

Plant Screening Notes:

There shall be a screening of plants that surround the kiosk and roll off containers from pedestrian views.

Plant screening seemed the most appropriate in the form of bougainvillea plants which would be potted and of which each pot would contain a trellis for the plants to grow upwards upon.

Plants to be placed 4'-0" on center

Note:

The colors of the roll-off bins will match (as closely as possible) to the rePlanet kiosks.

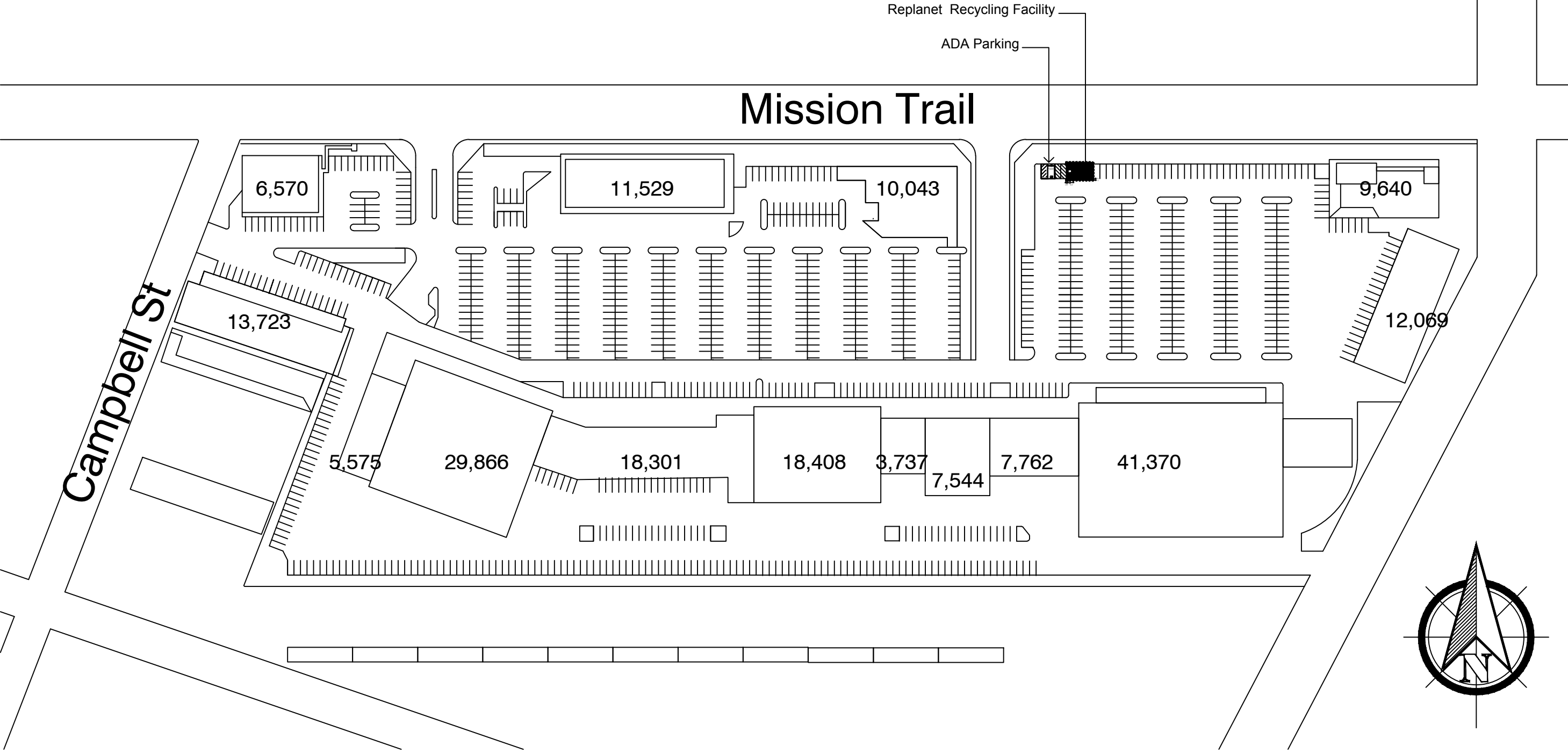

SITE PLAN

Scale: 1/128" = 1'-0"

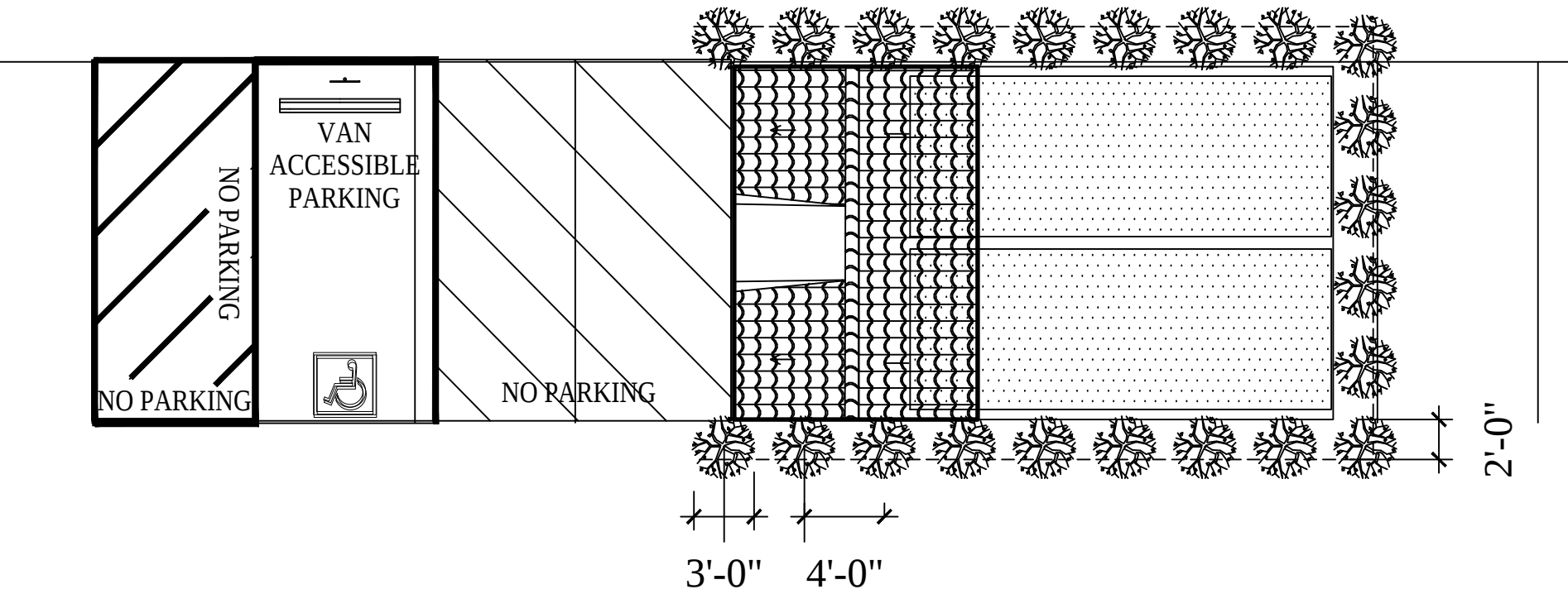

PLANT PLAN

Scale: 1/8" = 1'-0"

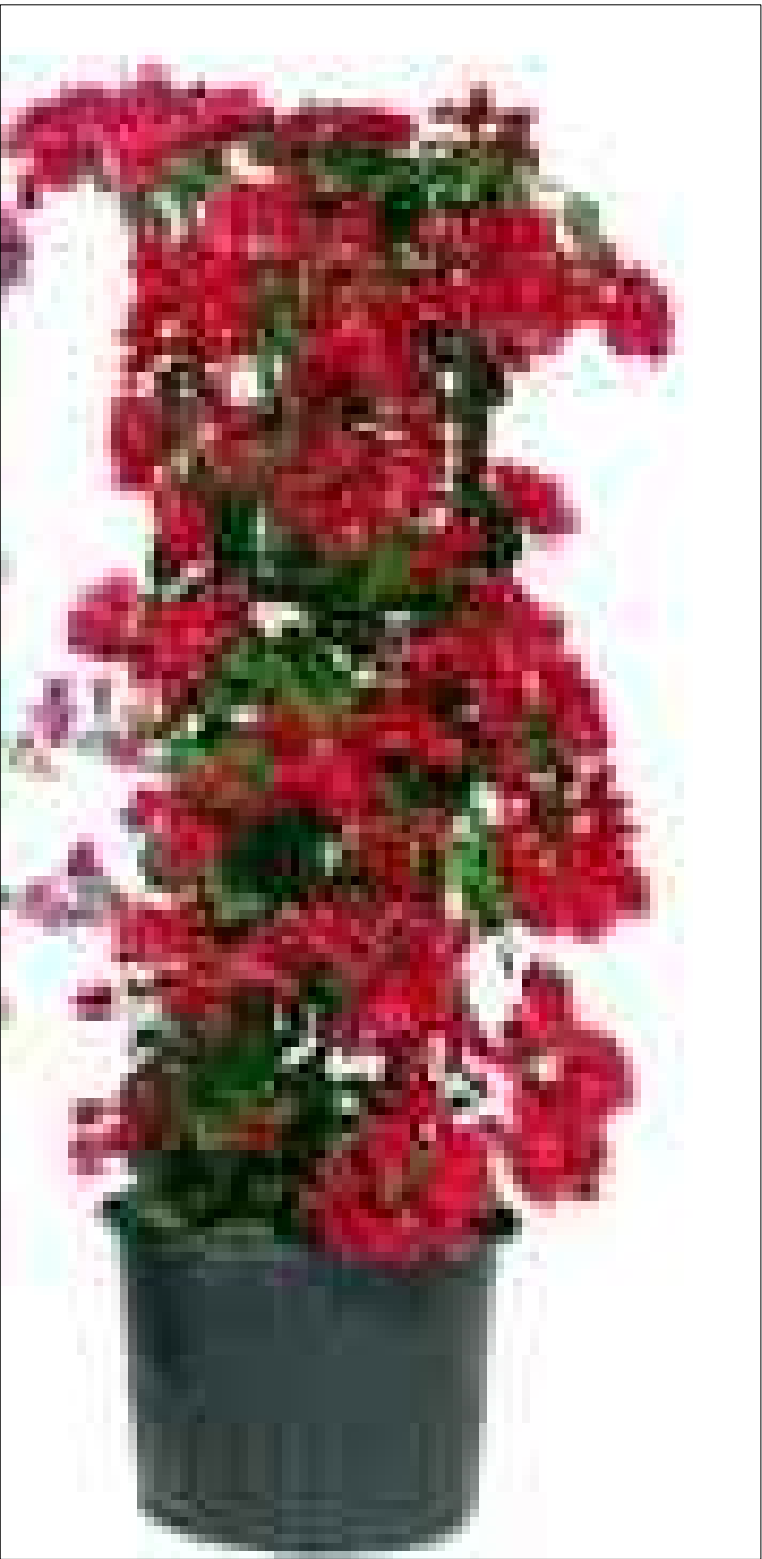

BOUGAINVILLEA POTTED PLANT WITH TRELLIS



PROPOSED BOUGAINVILLEA SCREENING PLANTS TO BE PLACED 4'-0" ON CENTER

City of Lake Elsinore
Community Development Department
Building & Safety Division
130 South Main Street
Lake Elsinore, CA 92530
Tel: (951) 674-3124
Fax (951) 471-1418

CITY JURISDICTION

ASSESSOR'S ID NO: 365280019-0
ADDRESS: 32281 MISSION TRAIL
LAKE ELSINORE, CA 92530
PROPERTY TYPE: COMMERCIAL
LEGAL DISCRIPTION: LOT 1 PM 140/041 PM21962
Jurisdiction: LAKE ELSINORE
Sphere of Influence: LAKE ELSINORE
Area Information
Recorded Size: 4.09 ACRES
Unit Structure Size: 496 sq ft

PARKING CALCULATIONS

STATER BROS 41,370 Sq Ft
TOTAL SQ FT OF ALL STRUCTURES 196,137 SQ FT
1 SPACE PER 250 SQ FT FLOOR AREA
REQUIRED PARKING: 784
PROVIDED PARKING: 1,014
OCCUPIED PARKING: 8
REMAINING PARKING: 222

PARKING CALCULATIONS

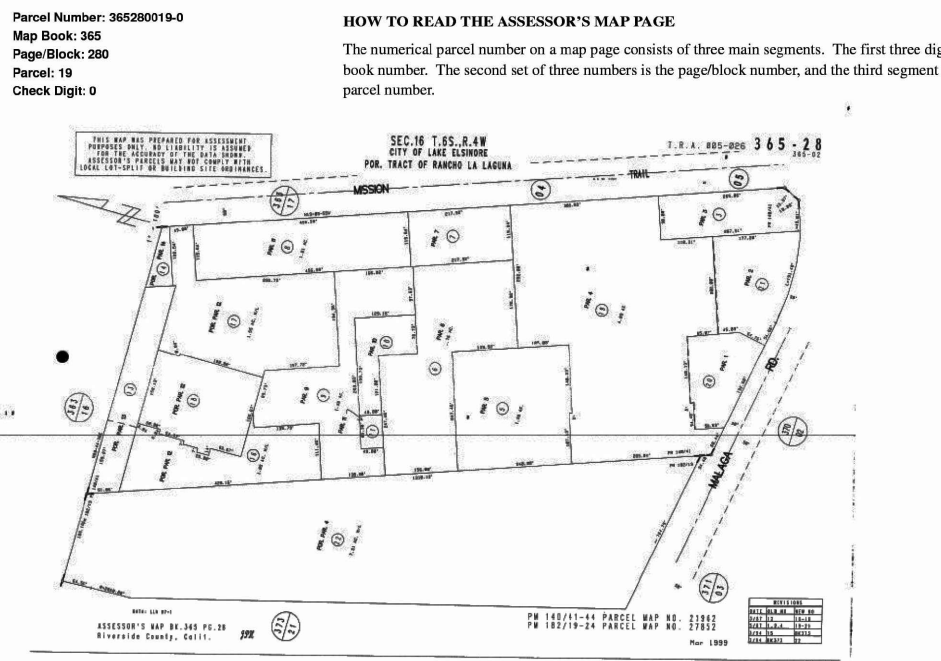

ASSESOR MAP



VICINITY MAP



SATELLITE IMAGE

Permit Advisors
The Permit Experts
8370 WILSHIRE BLVD #330
BEVERLY HILLS, CA 90211
T 310-275-7774
FAX: 310-881-1135
WWW.PERMITADVISORS.COM

PROJECT NAME AND ADDRESS:

rePlanet
REPLANET RECYCLING
@STATER BROTHERS #189
32281 MISSION TRAIL
LAKE ELSINORE, CA 92530

CONSULTANT:

PLANS DRAWN BY:

DANIEL MARZIGLIANO
ARCHITECTURAL DESIGNER
310.860.0760

REVISIONS:

NO.	REVISION/ISSUE	DATE
01		

PROJECT INFORMATION:

PROJECT:	
DATE:	8.28.2018
SCALE:	

SHEET TITLE:

SITE PLAN

SHEET NUMBER:

SP-1