

CITY OF LAKE ELSINORE

Public Hearing Report



CFD NO. 2019-1 (WESTLAKE)

AUGUST 13, 2019



SPICER CONSULTING
G R O U P

Table of Contents

Sections

1	Introduction	1
2	Description of Facilities	2
3	Cost Estimate	3
4	Proposed Development	4
5	Rate and Method of Apportionment	5
6	Certifications	6

Tables

3-1	Cost Estimate	3
-----	---------------	---

Appendices

A	Rate and Method of Apportionment
B	Boundary Map
C	Resolution of Intention

Background

On June 25, 2019, the City Council (the “City Council”) of the City of Lake Elsinore (the “City”), adopted a Resolution of Intention to form Community Facilities District No. 2019-1 (Westlake) of the City of Lake Elsinore (the “CFD No. 2019-1”), Resolution No. 2019-058, pursuant to the provisions of the “Mello-Roos Community Facilities Act of 1982”, being Chapter 2.5, Part 1, Division 2, Title 5 of the Government Code of the State of California, (the “Act”).

CFD No. 2019-1 is currently comprised of two parcels and approximately 19.47 gross acres. A tentative Tract Map 33267 includes 163 proposed detached condominium residential properties. The properties are located north of the intersection of Riverside Drive and Grand Avenue.

For a map showing the boundaries of CFD No. 2019-1 please see Appendix B.

Purpose of Public Hearing Report

WHEREAS, this Community Facilities District Report (“Report”) is being provided to the City Council and generally contains the following:

1. A brief description of CFD No. 2019-1;
2. A brief description of the Facilities required at the time of formation to meet the needs of CFD No. 2019-1.
3. A brief description of the Boundaries of CFD No. 2019-1; and
4. An estimate of the cost of financing the bonds used to pay for the Facilities, including all costs associated with formation of the District, issuance of bonds, determination of the amount of any special taxes, collection of any special taxes, or costs otherwise incurred in order to carry out the authorized purposes of the City with respect to the District, and any other incidental expenses to be paid through the proposed financing.

For particulars, reference is made to the Resolution of Intention as previously approved and adopted and is included in Appendix C.

NOW, THEREFORE, the undersigned, authorized representative of Spicer Consulting Group, LLC, the appointed responsible officer, or person directed to prepare this Report, does hereby submit the following data:

Description of the Facilities

A Community Facilities District may pay for facilities which may include all amounts necessary to eliminate any fixed special assessment liens or to pay, repay, or defease any obligation to pay for any indebtedness secured by any tax, fee, charge, or assessment levied, provide for the purchase, construction, expansion, or rehabilitation for any real or other tangible property with an estimated useful life of five (5) years or longer, which is necessary to meet increased demands placed upon local agencies as a result of development and/or rehabilitation occurring within the District.

The types of facilities that are proposed by CFD No. 2019-1 and financed with the proceeds of special taxes and bonds issued by CFD No. 2019-1 consist of the construction, purchase, modification, expansion, rehabilitation and/or improvement of (i) drainage, library, park, roadway, traffic, administration and community center facilities, marina and animal shelter facilities, and other public facilities of the City, including the foregoing public facilities which are included in the City's fee programs with respect to such facilities and authorized to be financed under the Mello-Roos Community Facilities Act of 1982, as amended (the "City Facilities") and (ii) water and sewer facilities including the acquisition of capacity in the sewer system and/or water system of the Elsinore Valley Municipal Water District which are included in Elsinore Valley Municipal Water District's water and sewer capacity and connection fee programs (the "Water District Facilities" and together, with the City Facilities, the "Facilities"), and all appurtenances and appurtenant work in connection with the foregoing Facilities, including the cost of engineering, planning, designing, materials testing, coordination, construction staking, construction management and supervision for such Facilities.

Incidental Expenses

The Incidental Expenses to be paid from bond proceeds and/or special taxes include:

- a) The cost of engineering, planning and designing the Facilities; and
- b) All costs, including costs of the property owner petitioning to form the District, associated with the creation of the District, the issuance of the bonds, the determination of the amount of special taxes to be levied and costs otherwise incurred in order to carry out the authorized purposes of the District; and
- c) Any other expenses incidental to the construction, acquisition, modification, rehabilitation, completion and inspection of the Facilities.

Capitalized terms used and not defined herein shall have the meaning set forth in the Rate and Method of Apportionment of Special Taxes for the District.

All costs associated with the creation of CFD No. 2019-1, the issuance of bonds, the determination of the amount of special taxes to be levied, costs incurred in order to carry out the authorized purposes of CFD No. 2019-1, including legal fees, fees of consultants, engineering, planning, designing and the annual costs to administer CFD No. 2019-1 and any obligations.

The description of the eligible public facilities, services and incidental expenses above are preliminary and general in nature. The final plans and specifications approved by the applicable public agency may show substitutes or modifications in order to accomplish the work or serve the new development and any such substitution or modification shall not constitute a change or modification in the proceedings relating to CFD No. 2019-1.

Below is the estimated cost of facilities to be provided to the District.

- a) The cost estimate of facilities, including incidental expenses, to be financed through the issuance of CFD No. 2019-1 Bonds is estimated to be \$6,285,000 based upon current dollars (Fiscal Year 2019-20).
- b) For further particulars please reference Table 3-1 below and incorporated herein by reference.
- c) Pursuant to Section 53340 of the Act, the proceeds of any special tax levied and collected by CFD No. 2019-1 may be used only to pay for the cost of providing public facilities, services, and incidental expenses. As defined by the Act, incidental expenses include, but are not limited to, the annual costs associated with determination of the amount of special taxes, collection of special taxes, payment of special taxes, or costs otherwise incurred in order to carry out the authorized purposes of the District. The incidental expenses associated with the annual administration of CFD No. 2019-1 are estimated to be \$30,000 in the initial Fiscal Year. However, it is anticipated that the incidental expenses will vary due to inflation and other factors that may not be foreseen today, and the actual incidental expenses may exceed these amounts accordingly.

Table 3-1
Cost Estimate

City of Lake Elsinore	Total	Bond Allocation⁽¹⁾
Traffic Impact Fee	\$156,317	\$156,317
Fire Facilities	\$99,756	\$99,756
Park Fee (Quimby)	\$260,800	\$260,800
City Hall & Public Works Facilities	\$65,852	\$65,852
Community Center Facilities	\$44,336	\$44,336
Marina Facilities	\$63,407	\$63,407
Animal Shelter Facility	\$28,362	\$28,362
Library Capitol Improvement Fund Fee	\$24,450	\$24,450
Storm Drain Capital Impact Fund Fee	\$117,373	\$117,373
Total City Fees	\$860,653	\$860,653

Elsinore Valley Municipal Water District	Total	Bond Allocation⁽¹⁾
Water & Sewer Connection Fee (3/4" Meter)	\$2,207,020	\$2,207,020
Sewer Capacity Fee	\$1,271,400	\$1,271,400
Irrigation Capacity Fee (1.5" Meter)	\$44,765	\$44,765
Water Facilities (Yellow Line - 100%)	\$291,097	\$291,097
Water Facilities (Pink Line - 100%)	\$323,510	\$323,510
Water Facilities (Red Line - 25%)	\$150,522	\$150,522
Total EVMWD	\$4,288,314	\$4,288,314

Total Eligible Fees/Improvements	\$5,148,967	\$5,146,967
Incidental Financing Costs		\$1,136,033
Total Funded by Bond Proceeds		\$6,285,000

Total Fees/Improvements to be Funded by Developer		\$0
--	--	------------

(1) Amounts are allocated based upon estimated bond sizing and may change abased upon market conditions at the time of bond issuance.

The CFD No. 2019-1 includes approximately 19.47 gross acres on two undeveloped assessor's parcels in Tract 33267 located in the City. The property within CFD No. 2019-1 is expected to be developed with 163 single family residential condominium units. The District is located just north of the corner of Riverside Drive and Grand Avenue. As of Fiscal Year 2019-20 the proposed CFD No. 2019-1 includes the following Assessor's Parcel Numbers:

Assessor Parcel Number
379-050-006
379-050-034

A map showing the boundaries of CFD No. 2019-1 is included in Appendix B.

The Rate and Method of Apportionment allows each property owner within CFD No. 2019-1 to estimate the annual Special Tax amount that would be required for payment. The Rate and Method of Apportionment of the Special Tax established pursuant to these proceedings, is attached hereto as Appendix A (the "Rate and Method"). The Special Tax will be collected in the same manner and at the same time as ordinary ad valorem property taxes and shall be subject to the same penalties, the same procedure, sale and lien priority in the case of delinquency; provided, however, that the CFD Administrator may directly bill the Special Taxes, may collect Special Taxes at a different time or in a different manner if necessary to meet the financial obligations of CFD No. 2019-1, and provided further that CFD No. 2019-1 may covenant to foreclose and may actually foreclose on parcels having delinquent Special Taxes as permitted by the Act.

All of the property located within CFD No. 2019-1, unless exempted by law or by the Rate and Method proposed for CFD No. 2019-1, shall be taxed for the purpose of providing necessary facilities to serve the District. The Boundary Map for CFD No. 2019-1 is attached hereto as Appendix B. Pursuant to Section 53325.3 of the Act, the tax imposed "is a Special Tax and not a special assessment, and there is no requirement that the tax be apportioned on the basis of benefit to any property." The Special Tax may be based on the benefit received by property, the cost of making facilities or authorized services available or other reasonable basis as determined by the City, although the Special Tax may not be apportioned on an ad valorem basis pursuant to Article XIII A of the California Constitution. A property owner within the District may choose to prepay in whole or in part the Special Tax. The available method for so doing is described in Section G of the Rate and Method ("Prepayment of Special Tax").

For each year that any Bonds are outstanding the Special Tax shall be levied on all parcels subject to the Special Tax. If any delinquent Special Taxes remain uncollected prior to or after all Bonds are retired, the Special Tax may be levied to the extent necessary to reimburse CFD No. 2019-1 for uncollected Special Taxes associated with the levy of such Special Taxes, but the Special Tax shall not be levied after 2059-2060 Fiscal Year.

For particulars as to the Rate and Method for CFD No. 2019-1, see the attached and incorporated in Appendix A.

Based on the information provided herein, it is my opinion that the described services herein are those that are necessary to meet increased demands placed upon the City of Lake Elsinore as a result of development occurring within the CFD No. 2019-1 and benefits the lands within said CFD No. 2019-1. Further, it is my opinion that the special tax rates and method of apportionment, as set forth herein, are fair and equitable, uniformly applied and not discriminating or arbitrary.

Date: August 13, 2019

SPICER CONSULTING GROUP, LLC



SHANE SPICER
SPECIAL TAX CONSULTANT FOR
CITY OF LAKE ELSINORE
RIVERSIDE COUNTY
STATE OF CALIFORNIA

APPENDIX A

Rate and Method of Apportionment



SPICER CONSULTING
G R O U P

**RATE AND METHOD OF APPORTIONMENT OF SPECIAL TAXES FOR
COMMUNITY FACILITIES DISTRICT NO. 2019-1 (WESTLAKE)
OF THE CITY OF LAKE ELSINORE**

A Special Tax (all capitalized terms are defined in Section A, "Definitions", below) shall be applicable to each Assessor's Parcel of Taxable Property located within the boundaries of the City of Lake Elsinore Community Facilities District No. 2019-1 (Westlake) ("CFD No. 2019-1"). The amount of Special Tax to be levied in each Fiscal Year on an Assessor's Parcel shall be determined by the City Council of the City of Lake Elsinore, acting in its capacity as the legislative body of CFD No. 2019-1, by applying the appropriate Special Tax for Developed Property, Approved Property, Undeveloped Property, and Provisional Undeveloped Property that is not Exempt Property as set forth below. All of the real property, unless exempted by law or by the provisions hereof in Section F, shall be taxed for the purposes, to the extent and in the manner herein provided.

A. DEFINITIONS

The terms hereinafter set forth have the following meanings:

"Acre or Acreage" means the land area of an Assessor's Parcel as shown on an Assessor's Parcel Map, or if the land area is not shown on an Assessor's Parcel Map, the land area shown on the applicable final map, parcel map, condominium plan, or other recorded County parcel map or instrument. The square footage of an Assessor's Parcel is equal to the Acreage multiplied by 43,560.

"Act" means the Mello-Roos Communities Facilities Act of 1982, as amended, being Chapter 2.5 (commencing with Section 53311) of Part 1 of Division 2 of Title 5 of the Government Code of the State of California.

"Administrative Expenses" means the following actual or reasonably estimated costs directly related to the administration of CFD No. 2019-1, including but not limited to: the costs of computing the Special Taxes and preparing the Special Tax collection schedules (whether by the City or designee thereof or both); the costs of collecting the Special Taxes (whether by the City or otherwise); the costs of remitting Special Taxes to the Trustee; the costs of the Trustee (including legal counsel) in the discharge of the duties required of it under the Indenture; the costs to the City, CFD No. 2019-1 or any designee thereof of complying with arbitrage rebate requirements; the costs to the City, CFD No. 2019-1 or any designee thereof of complying with disclosure requirements of the City, CFD No. 2019-1 or obligated persons associated with applicable federal and state securities laws and the Act; the costs associated with preparing Special Tax disclosure statements and responding to public inquiries regarding the Special Taxes; the costs of the City, CFD No. 2019-1 or any designee thereof related to an appeal of the Special Tax; the costs associated with the release of funds from an escrow account; and the City's annual administration fees and third party expenses. Administration Expenses shall also include amounts estimated by the CFD Administrator or advanced by the City or CFD No. 2019-1 for any other administrative purposes of CFD No. 2019-1, including attorney's fees and other costs related to commencing and pursuing to completion any foreclosure of delinquent Special Taxes.

"Approved Property" means all Assessor's Parcels of Taxable Property: (i) that are included in a Final Map that was recorded prior to the January 1st preceding the Fiscal Year in which the Special Tax is being levied, (ii) and has an assigned Assessor's Parcel Number from the County shown on an Assessor's Parcel Map for the individual lot included on the Final Map, and (iii) that have not been issued a building permit on or before May 1st preceding the Fiscal Year in which the Special Tax is being levied.

"Assessor's Parcel" means a lot or parcel of land designated on an Assessor's Parcel Map with an assigned Assessor's Parcel Number.

"Assessor's Parcel Map" means an official map of the Assessor of the County designating parcels by Assessor's Parcel Number.

"Assessor's Parcel Number" means that number assigned to an Assessor's Parcel by the County for purposes of identification.

"Assigned Special Tax" means the Special Tax of that name described in Section D below.

"Backup Special Tax" means the Special Tax of that name described in Section D below.

"Boundary Map" means a recorded map of the CFD which indicates the boundaries of the CFD.

"Bonds" means any obligation to repay a sum of money, including obligations in the form of bonds, notes, certificates of participation, long-term leases, loans from government agencies, or loans from banks, other financial institutions, private businesses, or individuals, or long-term contracts, or any refunding thereof, to which Special Tax of CFD No. 2019-1 have been pledged.

"Building Permit" means the first legal document issued by a local agency giving official permission for new construction. For purposes of this definition, "Building Permit" may or may not include any subsequent building permit document(s) authorizing new construction on an Assessor's Parcel that are issued or changed by the City after the first original issuance, as determined by the CFD Administrator as necessary to fairly allocate Special Tax to the Assessor's Parcel, provided that following such determination the Maximum Special Tax that may be levied on all Assessor's Parcels of Taxable Property will be at least 1.1 times maximum annual debt service on all outstanding Bonds plus the estimated annual Administrative Expenses.

"Building Square Footage" or "BSF" means the square footage of assessable internal living space, exclusive of garages or other structures not used as living space, as determined by reference to the Building Permit for such Assessor's Parcel.

"Calendar Year" means the period commencing January 1 of any year and ending the following December 31.

"CFD Administrator" means an official of the City, or designee thereof, responsible for determining the Special Tax Requirement, and providing for the levy and collection of the Special Taxes.

"CFD" or "CFD No. 2019-1" means Community Facilities District No. 2019-1 (Westlake) established by the City under the Act.

"City" means the City of Lake Elsinore.

"City Council" means the City Council of the City of Lake Elsinore, acting as the Legislative Body of CFD No. 2019-1.

"Condominium Plan" means a condominium plan as set forth in the California Civil Code, Section 4285.

"County" means the County of Riverside.

"Developed Property" means all Assessor's Parcels of Taxable Property that: (i) are included in a Final Map that was recorded prior to the January 1st preceding the Fiscal Year in which the Special Tax is being levied, and (ii) has an Assessor's Parcel Number from the County shown on an Assessor's Parcel Map for the individual lot included on the Final Map, and (iii) a Building Permit for new construction was issued on or before May 1st preceding the Fiscal Year in which the Special Tax is being levied.

"Exempt Property" means all Assessor's Parcels designated as being exempt from Special Taxes as provided for in Section F.

"Final Map" means a subdivision of property by recordation of a final map, parcel map, or lot line adjustment, pursuant to the Subdivision Map Act (California Government Code Section 66410 et seq.) or recordation of a Condominium Plan pursuant to California Civil Code Section 1352 that creates individual lots for which Building Permits may be issued without further subdivision.

"Fiscal Year" means the period commencing on July 1st of any year and ending the following June 30th.

"Indenture" means the indenture, fiscal agent agreement, resolution or other instrument pursuant to which Bonds are issued, as modified, amended and/or supplemented from time to time, and any instrument replacing or supplementing the same.

"Land Use Category" means any of the categories listed in Table 1 of Section D.

"Maximum Special Tax" means for each Assessor's Parcel, the maximum Special Tax, determined in accordance with Section D below, that can be levied by CFD No. 2019-1 in any Fiscal Year on such Assessor's Parcel.

"Multifamily Property" means all Assessor's Parcels of Developed Property for which a Building Permit has been issued for the purpose of constructing a building or buildings comprised of attached Residential Units available for rental by the general public, not for sale to an end user, and under common management, as determined by the CFD Administrator.

"Non-Residential Property" or **"NR"** means all Assessor's Parcels of Taxable Property for which a building permit(s) was issued for a non-residential use. The CFD Administrator shall make the determination if an Assessor's Parcel is Non-Residential Property.

"Partial Prepayment Amount" means the amount required to prepay a portion of the Special Tax obligation for an Assessor's Parcel, as described in Section G.2.

"Prepayment Amount" means the amount required to prepay the Special Tax obligation in full for an Assessor's Parcel, as described in Section G.1.

"Proportionately" means for Taxable Property that is (i) Developed Property, that the ratio of the actual Special Tax levy to the Assigned Special Tax is the same for all Assessor's Parcels of Developed Property, (ii) Approved Property, that the ratio of the actual Special Tax levy to the Maximum Special Tax is the same for all Assessor's Parcels of Approved Property, and (iii) Undeveloped Property, or Provisional Undeveloped Property, that the ratio of the actual Special Tax levy per Acre to the Maximum Special Tax

per Acre is the same for all Assessor's Parcels of Undeveloped Property, or Provisional Undeveloped Property, as applicable.

"Provisional Undeveloped Property" means all Assessor's Parcels of Taxable Property that would otherwise be classified as Exempt Property pursuant to the provisions of Section F, but cannot be classified as Exempt Property because to do so would be reduce the Acreage of all Taxable Property below the required minimum Acreage set forth in Sections F.

"Residential Property" means all Assessor's Parcels of Developed Property for which a building permit has been issued for purposes of constructing one or more Residential Units.

"Residential Unit" or **"RU"** means a residential unit that is used or intended to be used as a domicile by one or more persons, as determined by the CFD Administrator.

"Single Family Residential Property" means all Assessor's Parcels of Residential Property other than Multifamily Property.

"Special Tax" means any of the special taxes authorized to be levied within CFD No. 2019-1 pursuant to the Act to fund the Special Tax Requirement.

"Special Tax Requirement " means the amount required in any Fiscal Year to pay: (i) the debt service or the periodic costs on all outstanding Bonds due in the Calendar Year that commences in such Fiscal Year, (ii) Administrative Expenses, (iii) the costs associated with the release of funds from an escrow account, (iv) any amount required to replenish any reserve funds established in association with the Bonds, (v) an amount equal to any anticipated shortfall due to Special Tax delinquencies, and (vi) for the collection or accumulation of funds for the acquisition or construction of facilities authorized by CFD No. 2019-1 or the payment of debt services on Bonds anticipated to be issued, provided that the inclusion of such amount does not cause an increase in the levy of Special Tax on Approved Property or Undeveloped Property as set forth in Steps Two or Three of Section E., less (vii) any amounts available to pay debt service or other periodic costs on the Bonds pursuant to the Indenture.

"Taxable Property" means all Assessor's Parcels within CFD No. 2019-1, which are not Exempt Property.

"Taxable Unit" means either a Residential Unit or an Acre.

"Tract(s)" means an area of land within a subdivision identified by a particular tract number on a Final Map approved for the subdivision.

"Trustee" means the trustee, fiscal agent, or paying agent under the Indenture.

"Undeveloped Property" means all Assessor's Parcels of Taxable Property which are not Developed Property, Approved Property, Provisional Undeveloped Property.

B. SPECIAL TAX

Commencing Fiscal Year 2020-2021 and for each subsequent Fiscal Year, the City Council shall levy Special Taxes on all Taxable Property, up to the applicable Maximum Special Tax, to fund the Special Tax Requirement.

C. ASSIGNMENT TO LAND USE CATEGORY FOR SPECIAL TAX

Each Fiscal Year, beginning with Fiscal Year 2020-2021, each Assessor's Parcel within CFD No. 2019-1 shall be classified as Taxable Property or Exempt Property. In addition, each Assessor's Parcel of Taxable Property shall be further classified as Developed Property, Approved Property, Undeveloped Property or Provisional Undeveloped Property.

Assessor's Parcels of Developed Property shall further be classified as Residential Property or Non-Residential Property. Each Assessor's Parcel of Residential Property shall further be classified as a Single Family Residential Property, or Multifamily Property. Each Assessor's Parcel of Single Family Residential Property shall be further categorized into Land Use Categories based on its Building Square Footage and assigned to its appropriate Assigned Special Tax rate.

In the event that an Assessor's Parcel for which one or more Building Permits have been issued and the County has not yet assigned final Assessor's Parcel Number(s) to the Residential Unit(s) (in accordance with the Final Map or Condominium Plan) on such Assessor's Parcel, the amount of the Special Tax levy on such Assessor's Parcel for each Fiscal Year shall be determined as follows: (1) the CFD Administrator shall first determine an amount of the Maximum Special Tax levy for such Assessor's Parcel, based on the classification of such Assessor's Parcel as Undeveloped Property; (2) the amount of the Special Tax levy for the Residential Units on such Assessor's Parcel for which Building Permits have been issued shall be determined based on the Developed Property Special Tax rates and shall be taxed as Developed Property in accordance with Step 1 of Section E below; and (3) the amount of the Special Tax levy on the Taxable Property in such Assessor's Parcel not subject to the Special Tax levy in clause (2) shall be equal to: (A) the percentage of the Maximum Special Tax rate levied on all other Undeveloped Property multiplied by the total of the amount determined in clause (1), less the amount determined in clause (2).

D. MAXIMUM SPECIAL TAX

1. Developed Property

The Maximum Special Tax for each Assessor's Parcel of Single Family Residential Property in any Fiscal Year shall be the greater of (i) the Assigned Special Tax or (ii) the Backup Special Tax.

The Maximum Special Tax for each Assessor's Parcel of Non-Residential Property or Multifamily Residential Property shall be the applicable Assigned Special Tax described in Table 1 of Section D.

a. Assigned Special Tax

Each Fiscal Year, each Assessor's Parcel of Single Family Residential Property, Multifamily Property, or Non-Residential Property shall be subject to an Assigned Special Tax. The Assigned Special Tax applicable to an Assessor's Parcel of Developed Property shall be determined pursuant to Table 1 below.

TABLE 1
ASSIGNED SPECIAL TAX FOR DEVELOPED PROPERTY

Land Use Category	Taxable Unit	Building Square Footage	Assigned Special Tax Per Taxable Unit
1. Single Family Residential Property	RU	Less than 1,900 sq. ft	\$2,142.00
2. Single Family Residential Property	RU	1,900 sq. ft to 2,100 sq. ft	\$2,255.00
3. Single Family Residential Property	RU	Greater than 2,100 sq. ft	\$2,332.00
4. Multifamily Property	Acre	N/A	\$34,929.00
5. Non-Residential Property	Acre	N/A	\$34,929.00

On each July 1, commencing July 1, 2021, the Assigned Special Tax rate for Developed Property shall be increased by two percent (2.00%) of the amount in effect in the prior Fiscal Year.

b. Multiple Land Use Categories

In some instances an Assessor's Parcel of Developed Property may contain more than one Land Use Type. The Maximum Special Tax levied on an Assessor's Parcel shall be the sum of the Maximum Special Tax for all Land Use Categories located on the Assessor's Parcel. The CFD Administrator's allocation to each type of property shall be final.

c. Backup Special Tax

The Backup Special Tax for an Assessor's Parcel within a Final Map classified or to be classified as Single Family Property shall be calculated according to the following formula.

$$B = (U \times A) / L$$

The terms above have the following meanings:

B = Backup Special Tax per Assessor's Parcel within the Final Map

U = Maximum Special Tax per Acre of Undeveloped Property per Section D.3 below

A = Acreage of Single Family Residential Property expected to exist in such Final Map at the time of calculation, as determined by the Administrator

L = Number of Residential Units expected to exist in such Final Map at the time of calculation, as determined by the Administrator.

In the event any portion of the Final Map is changed or modified, the Backup Special Tax for all Assessor's Parcels within such changed or modified area shall be \$34,929 per Acre.

In the event any superseding Final Map is recorded as a Final Map within the Boundaries of the CFD, the Backup Special Tax for all Assessor's Parcels within such Final Map shall be \$34,929 per Acre. The Backup Special Tax shall not apply to Multifamily Residential Property, or Non-Residential Property.

On each July 1, commencing July 1, 2021, the Backup Special Tax rate shall be increased by two percent (2.00%) of the amount in effect in the prior Fiscal Year.

2. Approved Property

The Maximum Special Tax for each Assessor's Parcel of Approved Property expected to be classified as Single Family Property shall be the Backup Special Tax computed pursuant to Section D.1.c above.

The Maximum Special Tax for each Assessor's Parcel of Approved Property expected to be classified as Multifamily Residential Property or Non-Residential Property shall be \$34,929 per Acre.

On each July 1, commencing July 1, 2021, the Maximum Special Tax rate for Approved Property shall be increased by two percent (2.00%) of the amount in effect in the prior Fiscal Year.

3. Undeveloped Property and Provisional Undeveloped Property that is not Exempt Property pursuant to the provisions of Section F

The Maximum Special Tax for each Assessor's Parcel of Undeveloped Property and Provisional Undeveloped Property that is not Exempt Property shall be equal to the product of \$34,929 multiplied by the Acreage of such Assessor's Parcel.

On each July 1, commencing July 1, 2021, the Maximum Special Tax rate for Undeveloped and Provisional Undeveloped Property shall be increased by two percent (2.00%) of the amount in effect in the prior Fiscal Year.

E. METHOD OF APPORTIONMENT OF THE SPECIAL TAX

Commencing Fiscal Year 2020-2021 and for each subsequent Fiscal Year, the City Council shall levy Special Taxes on all Taxable Property in accordance with the following steps:

- Step One: The Special Tax shall be levied Proportionately on each Assessor's Parcel of Developed Property at up to 100% of the applicable Assigned Special Tax rates in Table 1 to satisfy the Special Tax Requirement.
- Step Two: If additional moneys are needed to satisfy the Special Tax Requirement after the first step has been completed, the Special Tax shall be levied Proportionately on each Assessor's Parcel of Approved Property at up to 100% of the Maximum Special Tax applicable to each such Assessor's Parcel as needed to satisfy the Special Tax Requirement.
- Step Three: If additional moneys are needed to satisfy the Special Tax Requirement after the first two steps have been completed, the Annual Special Tax shall be levied Proportionately on each Assessor's Parcel of Undeveloped Property up to 100% of the Maximum Special Tax applicable to each such Assessor's Parcel as needed to satisfy the Special Tax Requirement.
- Step Four: If additional moneys are needed to satisfy the Special Tax Requirement after the first three steps have been completed, then the Special Tax levy on each Assessor's Parcel of Developed Property for which the Maximum Special Tax is the Backup Special Tax shall be increased Proportionately from the Assigned Special Tax up to 100% of the Backup Special Tax as needed to satisfy the Special Tax Requirement.

Step Five: If additional moneys are needed to satisfy the Special Tax Requirement after the first four steps have been completed, the Special Tax shall be levied Proportionately on each Assessor's Parcel of Provisional Undeveloped Property up to 100% of the Maximum Special Tax applicable to each such Assessor's Parcel as needed to satisfy the Special Tax Requirement.

Notwithstanding the above, under no circumstances will the Special Taxes levied in any Fiscal Year against any Assessor's Parcel of Residential Property as a result of a delinquency in the payment of the Special Tax applicable to any other Assessor's Parcel be increased by more than ten percent (10%) above the amount that would have been levied in that Fiscal Year had there never been any such delinquency or default.

F. EXEMPTIONS

The City shall classify as Exempt Property, in the following order of priority, (i) Assessor's Parcels which are owned by, irrevocably offered for dedication, encumbered by or restricted in use by the State of California, Federal or other local governments, including school districts, (ii) Assessor's Parcels which are used as places of worship and are exempt from *ad valorem* property taxes because they are owned by a religious organization, (iii) Assessor's Parcels which are owned by, irrevocably offered for dedication, encumbered by or restricted in use by a homeowners' association, (iv) Assessor's Parcels with public or utility easements making impractical their utilization for other than the purposes set forth in the easement, (v) Assessor's Parcels which are privately owned and are encumbered by or restricted solely for public uses, or (vi) Assessor's Parcels restricted to other types of public uses determined by the City Council, provided that no such classification would reduce the sum of all Taxable Property to less than 11.68 Acres.

Notwithstanding the above, the City Council shall not classify an Assessor's Parcel as Exempt Property if such classification would reduce the sum of all Taxable Property to less than 11.68 Acres. Assessor's Parcels which cannot be classified as Exempt Property because such classification would reduce the Acreage of all Taxable Property to less than 11.68 Acres will be classified as Provisional Undeveloped Property, and will be subject to Special Tax pursuant to Step Five in Section E.

G. PREPAYMENT OF SPECIAL TAX

The following additional definitions apply to this Section G:

"CFD Public Facilities" means \$7,000,000 expressed in 2020 dollars, which shall increase by the Construction Inflation Index on July 1, 2021, and on each July 1 thereafter, or such lower amount (i) determined by the City Council as sufficient to provide the public facilities under the authorized bonding program for CFD No. 2019-1, or (ii) determined by the City Council concurrently with a covenant that it will not issue any more Bonds to be supported by Special Tax levied under this Rate and Method of Apportionment.

"Construction Fund" means an account specifically identified in the Indenture or functionally equivalent to hold funds, which are currently available for expenditure to acquire or construct public facilities eligible to be financed by CFD No. 2019-1.

"Construction Inflation Index" means the annual percentage change in the Engineering News-Record Building Cost Index for the city of Los Angeles, measured as of the Calendar Year which ends in the

previous Fiscal Year. In the event this index ceases to be published, the Construction Inflation Index shall be another index as determined by the City that is reasonably comparable to the Engineering News-Record Building Cost Index for the city of Los Angeles.

“Future Facilities Costs” means the CFD Public Facilities minus public facility costs available to be funded through existing construction or escrow accounts funded by the Outstanding Bonds, and minus public facility costs funded by interest earnings on the Construction Fund actually earned prior to the date of prepayment.

“Outstanding Bonds” means all previously issued Bonds issued and secured by the levy of Special Tax which will remain outstanding after the first interest and/or principal payment date following the current Fiscal Year, excluding Bonds to be redeemed at a later date with the proceeds of prior prepayments of Special Tax.

1. Prepayment in Full

The Maximum Special Tax obligation may be prepaid and permanently satisfied for (i) Assessor’s Parcels of Developed Property, (ii) Assessor’s Parcels of Approved Property or Undeveloped Property for which a Building Permit has been issued, (iii) Approved Property or Undeveloped Property for which a Building Permit has not been issued and (iv) Assessor’s Parcels of Public Property or Property Owner’s Association Property, or Provisional Undeveloped Property that are not Exempt Property pursuant to Section F. The Maximum Special Tax obligation applicable to an Assessor’s Parcel may be fully prepaid and the obligation to pay the Special Tax for such Assessor’s Parcel permanently satisfied as described herein; provided that a prepayment may be made only if there are no delinquent Special Taxes with respect to such Assessor’s Parcel at the time of prepayment. An owner of an Assessor’s Parcel intending to prepay the Maximum Special Tax obligation for such Assessor’s Parcel shall provide the CFD Administrator with written notice of intent to prepay, and within 5 business days of receipt of such notice, the CFD Administrator shall notify such owner of the amount of the non-refundable deposit determined to cover the cost to be incurred by the CFD in calculating the Prepayment Amount (as defined below) for the Assessor’s Parcel. Within 15 days of receipt of such non-refundable deposit, the CFD Administrator shall notify such owner of the Prepayment Amount for the Assessor’s Parcel. Prepayment must be made not less than 60 days prior to the redemption date for any Bonds to be redeemed with the proceeds of such prepaid Special Taxes.

The Prepayment Amount (defined below) shall be calculated as follows (capitalized terms are defined below):

	Bond Redemption Amount
plus	Redemption Premium
plus	Future Facilities Amount
plus	Defeasance Amount
plus	Administrative Fees and Expenses
less	Reserve Fund Credit
Equals:	Prepayment Amount

The Prepayment Amount shall be determined as of the proposed prepayment date as follows:

1. Confirm that no Special Tax delinquencies apply to such Assessor’s Parcel.

2. For an Assessor's Parcel of Developed Property, compute the Maximum Special Tax for the Assessor's Parcel. For an Assessor's Parcel of Approved Property or Undeveloped Property for which a Building Permit has been issued, compute the Maximum Special Tax for the Assessor's Parcel as though it was already designated as Developed Property, based upon the Building Permit which has been issued for the Assessor's Parcel. For an Assessor's Parcel of Approved Property or Undeveloped Property for which a Building Permit has not been issued, Public Property, Property Owner's Association Property, or Provisional Undeveloped Property to be prepaid compute the Maximum Special Tax for the Assessor's Parcel.
3. Divide the Maximum Special Tax derived pursuant to paragraph 2 by the total amount of Special Taxes that could be levied at the Maximum Special Tax at build out of all Assessor's Parcels of Taxable Property based on the applicable Maximum Special Tax for Assessor's Parcels of Developed Property not including any Assessor's Parcels for which the Special Tax obligation has been previously prepaid.
4. Multiply the quotient derived pursuant to paragraph 3 by the principal amount of the Outstanding Bonds to determine the amount of Outstanding Bonds to be redeemed with the Prepayment Amount (the "Bond Redemption Amount").
5. Multiply the Bond Redemption Amount by the applicable redemption premium, if any, on the Outstanding Bonds to be redeemed (the "Redemption Premium").
6. Determine the Future Facilities Costs.
7. Multiply the quotient derived pursuant to paragraph 3 by the amount determined pursuant to paragraph 6 to determine the amount of Future Facilities Costs for the Assessor's Parcel (the "Future Facilities Amount").
8. Determine the amount needed to pay interest on the Bond Redemption Amount from the first bond interest and/or principal payment date following the current Fiscal Year until the earliest redemption date for the Outstanding Bonds on which Bonds can be redeemed from Special Tax prepayments.
9. Determine the Special Taxes levied on the Assessor's Parcel in the current Fiscal Year which have not yet been paid.
10. Determine the amount the CFD Administrator reasonably expects to derive from the investment of the Bond Redemption Amount and the Redemption Premium from the date of prepayment until the redemption date for the Outstanding Bonds to be redeemed with the Prepayment Amount.
11. Add the amounts derived pursuant to paragraphs 8 and 9 and subtract the amount derived pursuant to paragraph 10 (the "Defeasance Amount").
12. Verify the administrative fees and expenses of the CFD, including the cost of computation of the Prepayment Amount, the cost to invest the Prepayment Amount, the cost of redeeming the Outstanding Bonds, and the cost of recording notices to evidence the prepayment of the Maximum Special Tax obligation for the Assessor's Parcel and the redemption of Outstanding Bonds (the

“Administrative Fees and Expenses”).

13. The reserve fund credit (the “Reserve Fund Credit”) shall equal the lesser of: (a) the expected reduction in the reserve requirement (as defined in the Indenture), if any, associated with the redemption of Outstanding Bonds as a result of the prepayment, or (b) the amount derived by subtracting the new reserve requirement (as defined in the Indenture) in effect after the redemption of Outstanding Bonds as a result of the prepayment from the balance in the reserve fund on the prepayment date, but in no event shall such amount be less than zero.

14. The Prepayment Amount is equal to the sum of the Bond Redemption Amount, the Redemption Premium, the Future Facilities Amount, the Defeasance Amount and the Administrative Fees and Expenses, less the Reserve Fund Credit.

15. From the Prepayment Amount, the Bond Redemption Amount, the Redemption Premium, and Defeasance Amount shall be deposited into the appropriate fund as established under the Indenture and be used to redeem Outstanding Bonds or make debt service payments. The Future Facilities Amount shall be deposited into the Construction Fund. The Administrative Fees and Expenses shall be retained by the CFD.

The Prepayment Amount may be sufficient to redeem other than a \$5,000 increment of Bonds. In such event, the increment above \$5,000 or an integral multiple thereof will be retained in the appropriate fund established under the Indenture to be used with the next redemption from other Special Tax prepayments of Outstanding Bonds or to make debt service payments.

As a result of the payment of the current Fiscal Year’s Special Tax levy as determined pursuant to paragraph 9 above, the CFD Administrator shall remove the current Fiscal Year’s Special Tax levy for the Assessor’s Parcel from the County tax roll. With respect to any Assessor’s Parcel for which the Maximum Special Tax obligation is prepaid, the City Council shall cause a suitable notice to be recorded in compliance with the Act, to indicate the prepayment of Maximum Special Tax obligation and the release of the Special Tax lien for the Assessor’s Parcel, and the obligation to pay the Special Tax for such Assessor’s Parcel shall cease.

Notwithstanding the foregoing, no Special Tax prepayment shall be allowed unless the amount of Maximum Special Tax that may be levied on all Assessor’s Parcels of Taxable Property after the proposed prepayment will be at least 1.1 times maximum annual debt service on the Bonds that will remain outstanding after the prepayment plus the estimated annual Administrative Expenses.

Tenders of Bonds in prepayment of the Maximum Special Tax obligation may be accepted upon the terms and conditions established by the City Council pursuant to the Act. However, the use of Bond tenders shall only be allowed on a case-by-case basis as specifically approved by the City Council.

2. Prepayment in Part

The Maximum Special Tax obligation for an Assessor’s Parcel of Developed Property, Approved Property or Undeveloped Property may be partially prepaid. For purposes of determining the partial prepayment amount, the provisions of Section G.1 shall be modified as provided by the following formula:

$$PP = ((P_E - A) \times F) + A$$

These terms have the following meaning:

PP = Partial Prepayment Amount

P_E = the Prepayment Amount calculated according to Section G.1

F = the percent by which the owner of the Assessor's Parcel(s) is partially prepaying the Maximum Special Tax obligation

A = the Administrative Fees and Expenses determined pursuant to Section G.1

The owner of an Assessor's Parcel who desires to partially prepay the Maximum Special Tax obligation for the Assessor's Parcel shall notify the CFD Administrator of (i) such owner's intent to partially prepay the Maximum Special Tax obligation, (ii) the percentage of the Maximum Special Tax obligation such owner wishes to prepay, and (iii) the company or agency that will be acting as the escrow agent, if any. Within 5 days of receipt of such notice, the CFD Administrator shall notify such property owner of the amount of the non-refundable deposit determined to cover the cost to be incurred by the CFD in calculating the amount of a partial prepayment. Within 15 business days of receipt of such non-refundable deposit, the CFD Administrator shall notify such owner of the amount of the Partial Prepayment Amount for the Assessor's Parcel. A Partial Prepayment Amount must be made not less than 60 days prior to the redemption date for the Outstanding Bonds to be redeemed with the proceeds of the Partial Prepayment Amount.

With respect to any Assessor's Parcel for which the Maximum Special Tax obligation is partially prepaid, the CFD Administrator shall (i) distribute the Partial Prepayment Amount as provided in Paragraph 15 of Section G.1, and (ii) indicate in the records of the CFD that there has been a Partial Prepayment for the Assessor's Parcel and that a portion of the Maximum Special Tax obligation equal to the remaining percentage (1.00 - F) of the Maximum Special Tax obligation will continue to be levied on the Assessor's Parcel pursuant to Section E.

H. TERMINATION OF SPECIAL TAX

For each Fiscal Year that any Bonds are outstanding the Special Tax shall be levied on all Assessor's Parcels subject to the Special Tax. The Special Tax shall cease not later than the 2059-2060 Fiscal Year, however, Special Tax will cease to be levied in an earlier Fiscal Year if the CFD Administrator has determined (i) that all the required interest and principal payments on the CFD No. 2019-1 Bonds have been paid; (ii) all authorized facilities of CFD No. 2019-1 have been acquired and all reimbursements to the developer have been paid, (iii) no delinquent Special Tax remain uncollected and (iv) all other obligations of CFD No. 2019-1 have been satisfied.

I. MANNER OF COLLECTION

The Special Tax shall be collected in the same manner and at the same time as ordinary *ad valorem* property taxes, provided, however, that CFD No. 2019-1 may collect Special Taxes at a different time or in a different manner if necessary to meet its financial obligations, and may covenant to foreclose and may actually foreclose on delinquent Assessor's Parcels as permitted by the Act.

J. APPEALS OF SPECIAL TAXES

Any taxpayer may file a written appeal of the Special Taxes on his/her Assessor's Parcel(s) with the CFD Administrator, provided that the appellant is current in his/her payments of Special Taxes. During pendency of an appeal, all Special Taxes previously levied must be paid on or before the payment date established when the levy was made. The appeal must specify the reasons why the appellant claims the

Special Tax is in error. The CFD Administrator shall review the appeal, meet with the appellant if the CFD Administrator deems necessary, and advise the appellant of its determination. If the CFD Administrator agrees with the appellant, the CFD Administrator shall grant a credit to eliminate or reduce future Special Taxes on the appellant's Assessor's Parcel(s). No refunds of previously paid Special Taxes shall be made.

The CFD Administrator shall interpret this Rate and Method of Apportionment and make determinations relative to the annual levy and administration of the Special Taxes and any taxpayer who appeals, as herein specified.

APPENDIX B

Boundary Map



SPICER CONSULTING
G R O U P

**AMENDED BOUNDARY MAP OF
COMMUNITY FACILITIES DISTRICT NO. 2019-1
(WESTLAKE)
CITY OF LAKE ELSINORE,
COUNTY OF RIVERSIDE, STATE OF CALIFORNIA**

THIS MAP AMENDS THE BOUNDARY MAP RECORDED IN BOOK 83 OF MAPS OF ASSESSMENT AND COMMUNITY FACILITIES DISTRICT PAGE 53 AS INSTRUMENT NO. 2019-0057541 IN THE OFFICE OF THE COUNTY RECORDER, COUNTY OF RIVERSIDE, STATE OF CALIFORNIA.

I HEREBY CERTIFY THAT THE WITHIN MAP SHOWING PROPOSED BOUNDARIES OF COMMUNITY FACILITIES DISTRICT NO. 2019-1 (WESTLAKE), CITY OF LAKE ELSINORE, COUNTY OF RIVERSIDE, STATE OF CALIFORNIA, WAS APPROVED BY THE CITY COUNCIL OF THE CITY OF LAKE ELSINORE AT A REGULAR MEETING THEREOF, HELD ON 25th DAY OF June, 2019, BY RESOLUTION NO. 2019-058

[REDACTED]
CITY CLERK
CITY OF LAKE ELSINORE

FILED IN THE OFFICE OF THE CITY CLERK, CITY OF LAKE ELSINORE, THIS 26th DAY OF June, 2019.

[REDACTED]
CITY CLERK
CITY OF LAKE ELSINORE

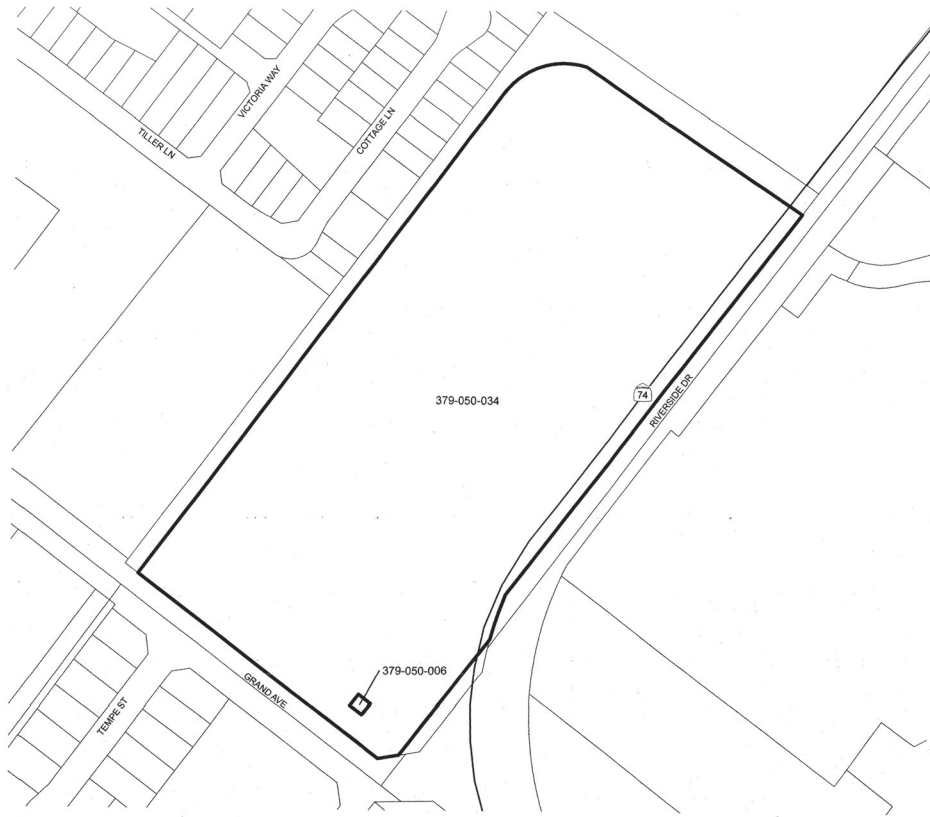
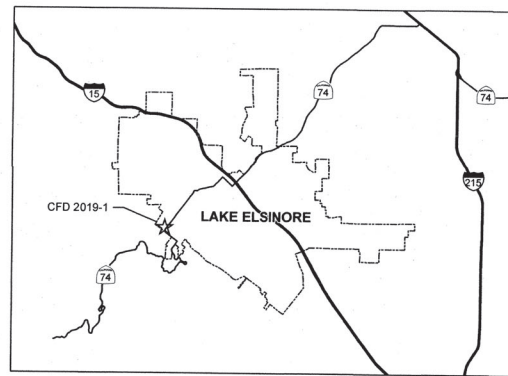

RECORDED THIS 3RD DAY OF July, 2019 AT THE HOUR OF 2:44 O'CLOCK P.M. IN BOOK 83 PAGE 916 OF MAPS OF ASSESSMENT AND COMMUNITY FACILITIES DISTRICTS IN THE OFFICE OF THE COUNTY RECORDER, IN THE COUNTY OF RIVERSIDE, STATE OF CALIFORNIA.

FEE: \$9.00 NO.: 2019-0244989
PETER ALDANA, ASSESSOR, COUNTY CLERK, RECORDER

BY: [REDACTED]
DEPUTY

LEGEND

- CFD BOUNDARY
- PARCEL LINE
- XXX-XXX-XXX ASSESSOR PARCEL NUMBER



THIS BOUNDARY MAP CORRECTLY SHOWS THE BOUNDARIES OF THE COMMUNITY FACILITIES DISTRICT. FOR DETAILS CONCERNING THE LINES AND DIMENSIONS OF LOTS OR PARCEL REFER TO THE COUNTY ASSESSOR'S MAPS FOR FISCAL YEAR 2019-20.

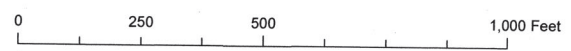

APPENDIX C

Resolution of Intention



SPICER CONSULTING
G R O U P

RESOLUTION NO. 2019-058

RESOLUTION OF INTENTION OF THE CITY COUNCIL OF THE CITY OF LAKE ELSINORE, CALIFORNIA, TO ESTABLISH COMMUNITY FACILITIES DISTRICT NO. 2019-1 OF THE CITY OF LAKE ELSINORE (WESTLAKE), TO AUTHORIZE THE LEVY OF A SPECIAL TAX TO PAY THE COSTS OF ACQUIRING OR CONSTRUCTING CERTAIN FACILITIES AND TO PAY DEBT SERVICE ON BONDED INDEBTEDNESS AND TO RESCIND RESOLUTION NO. 2019-004

Whereas, pursuant to a petition signed by Pardee Homes, a California corporation ("Pardee"), which petition met the requirements of Sections 53318 and 53319 of the Government Code of the State of California, the City Council (the "City Council") of the City of Lake Elsinore (the "City") adopted Resolution No. 2019-004 on February 12, 2019, declaring its intention to form "Community Facilities District No. 2019-1 of the City of Lake Elsinore (Westlake)" ("Community Facilities District No. 2019-1" or the "District") pursuant to the Mello-Roos Community Facilities Act of 1982, as amended, commencing with Section 53311 of the Government Code (the "Act"); and,

Whereas, pursuant to Resolution No. 2019-004, the City Council called a public hearing on matters related to the formation of the District in accordance with the Act; and,

Whereas, subsequent to the adoption of Resolution No. 2019-004 but prior to the public hearing mentioned above, Pardee notified the City that additional public facilities are required with respect to the development in the proposed District which necessitates revisions to the rate and method of apportionment of special tax for the District attached to Resolution No. 2019-004 and an increase in the amount of bonded indebtedness to be incurred in the District to finance such facilities; and,

Whereas, the public hearing called pursuant to Resolution No. 2019-004 was cancelled; and,

Whereas, the City has received a petition from Pardee, the owner of more than ten percent of the land within the boundaries of the territory which is proposed for inclusion in the District, to re-initiate the proceedings for the formation of the District, which petition meets the requirements of Sections 53318 and 53319 of the Government Code of the State of California; and,

Whereas, the City Council desires to rescind Resolution No. 2019-004 and to adopt this resolution of intention as provided in Section 53321 of the Act to establish the District consisting of the territory described in Attachment "A" hereto and incorporated herein by this reference to finance (1) the purchase, construction, modification, expansion, improvement or rehabilitation of certain real or other tangible property described in Attachment "B" hereto and incorporated herein by this reference, including all furnishings, equipment and supplies related thereto (collectively, the "Facilities"), which Facilities have a useful life of five years or longer, and (2) the incidental expenses to be incurred in connection with financing the Facilities and forming and administering the District (the "Incidental Expenses"); and,

Whereas, the City Council further intends to approve an estimate of the costs of the Facilities and the Incidental Expenses for Community Facilities District No. 2019-1; and,

Whereas, it is the intention of the City Council to consider financing the Facilities and the Incidental Expenses through the formation of Community Facilities District No. 2019-1 and the issuance of bonded indebtedness in an amount not to exceed \$8,000,000 with respect to the

Facilities and the Incidental Expenses and the levy of a special tax to pay for the Facilities and the Incidental Expenses (the "Special Tax") and to pay debt service on the bonded indebtedness, provided that the bond sale and such Special Tax levy are approved at an election to be held within the boundaries of Community Facilities District No. 2019-1; and,

Whereas, the City desires to enter into a reimbursement agreement with Pardee Homes, a California corporation (the "Developer"), the form of which is on file with the City Clerk (the "Reimbursement Agreement"), to provide for the reimbursement of certain amounts advanced by the Developer in connection with the formation of the District; and,

Whereas, the District, the Developer and the Elsinore Valley Municipal Water District (the "Water District") proposes to enter into a Joint Community Facilities Agreement (the "JCFA") relating to certain facilities proposed to be financed by the District and owned and operated by the Water District, and the District expects to enter into the JCFA prior to the approval of the issuance of bonds pursuant to the Act.

NOW, THEREFORE, THE CITY COUNCIL OF THE CITY OF LAKE ELSINORE DOES HEREBY RESOLVE, DETERMINE AND ORDER AS FOLLOWS:

Section 1. The above recitals are true and correct.

Section 2. The City Council hereby rescinds Resolution No. 2019-004 and this Resolution shall supersede Resolution No. 2019-004 in all respects and for all purposes in connection with the formation of the District.

Section 3. A community facilities district is proposed to be established under the terms of the Act. It is further proposed that the boundaries of the community facilities district shall be the legal boundaries as described in Attachment "A" hereto, which boundaries shall, upon recordation of the boundary map for the District, include the entirety of any parcel subject to taxation by the District, and as depicted on the map of the proposed Community Facilities District No. 2019-1 which is on file with the City Clerk. The City Clerk is hereby directed to sign the original map of the District and record it with all proper endorsements thereon with the Assessor-County Clerk-Recorder of the County of Riverside (the "County Recorder") within 15 days after the adoption of this resolution, all as required by Section 3111 of the Streets and Highways Code of the State of California.

The boundary map attached as Attachment A to Resolution No. 2019-004 and recorded with the County Recorder on February 20, 2019 as Document No. 2019-0057541 shall be superseded and replaced by the boundary map set forth in Attachment "A" hereto.

Section 4. The name of the proposed community facilities district shall be "Community Facilities District No. 2019-1 of the City of Lake Elsinore (Westlake)."

Section 5. The Facilities proposed to be provided within Community Facilities District No. 2019-1 are public facilities as defined in the Act, which the City and the Water District, with respect to certain water and sewer facilities, are authorized by law to construct, acquire, own and operate. The City Council hereby finds and determines that the description of the Facilities herein is sufficiently informative to allow taxpayers within the proposed District to understand what the funds of the District may be used to finance. The Incidental Expenses expected to be incurred include the cost of planning and designing the Facilities, the costs of forming the District, issuing bonds and levying and collecting the Special Tax within the proposed District. The Facilities may

be acquired from one or more of the property owners within the District as completed public improvements or may be constructed from bond or Special Tax proceeds.

All or a portion of the Facilities may be purchased with District funds as completed public facilities pursuant to Section 53314.9 or as discrete portions or phases pursuant to Section 53313.51 of the Act and/or constructed with District funds pursuant to Section 53316.2 of the Act. Any portion of the Facilities may be financed through a lease or lease-purchase arrangement if the District hereafter determines that such arrangement is of benefit to the District.

Section 6. Except where funds are otherwise available, it is the intention of the City Council to levy annually in accordance with the procedures contained in the Act the Special Tax, secured by recordation of a continuing lien against all nonexempt real property in the District, sufficient to pay for: (i) the Facilities and Incidental Expenses; and (ii) the principal and interest and other periodic costs on bonds or other indebtedness issued to finance the Facilities and Incidental Expenses, including the establishment and replenishment of any reserve funds deemed necessary by the District, and any remarketing, credit enhancement and liquidity facility fees (including such fees for instruments which serve as the basis of a reserve fund in lieu of cash). The rate and method of apportionment and manner of collection of the Special Tax are described in detail in Attachment "C" attached hereto, which Attachment "C" is incorporated herein by this reference. Attachment "C" allows each landowner within the District to estimate the maximum amount of the Special Tax that may be levied against each parcel. In the first year in which such Special Tax is levied, the levy shall include an amount sufficient to repay to the District all amounts, if any, transferred to the District pursuant to Section 53314 of the Act and interest thereon.

If the Special Tax is levied against any parcel used for private residential purposes, (i) the maximum Special Tax rate shall be specified as a dollar amount which shall be calculated and established not later than the date on which the parcel is first subject to the Special Tax because of its use for private residential purposes and shall not be increased over time, except as set forth in Attachment "C" hereto, (ii) such Special Tax not shall be levied after fiscal year 2059-60, as described in Attachment "C" hereto, and (iii) under no circumstances will the Special Tax levied in any fiscal year against any such parcel used for private residential uses be increased as a consequence of delinquency or default by the owner or owners of any other parcel or parcels within the District by more than ten percent (10%) above the amount that would have been levied in that fiscal year had there never been any such delinquencies or defaults.

The Special Tax is based on the expected demand that each parcel of real property within proposed Community Facilities District No. 2019-1 will place on the Facilities and on the benefit that each parcel derives from the right to access the Facilities. The City Council hereby determines that the proposed Facilities are necessary to meet the increased demand placed upon the City and the existing infrastructure in the City as a result of the development of the land proposed for inclusion in the District. The City Council hereby determines the rate and method of apportionment of the special tax with respect to the Special Tax set forth in Attachment "C" to be reasonable. The Special Tax is apportioned to each parcel on the foregoing basis pursuant to Section 53325.3 of the Act and such special tax is not on or based upon the value or ownership of real property. In the event that a portion of the property within Community Facilities District No. 2019-1 shall become for any reason exempt, wholly or partially, from the levy of the Special Tax specified on Attachment "C," the City Council shall, on behalf of Community Facilities District No. 2019-1, cause the levy to be increased, subject to the limitation of the maximum Special Tax for a parcel as set forth in Attachment "C," to the extent necessary upon the remaining property within proposed Community Facilities District No. 2019-1 which is not exempt in order to yield the

Special Tax revenues required for the purposes described in this Section 6. The obligation to pay the Special Tax may be prepaid only as set forth in Section G of Attachment "C" hereto.

Section 7. A public hearing (the "Hearing") on the establishment of the proposed Community Facilities District No. 2019-1, the proposed rate and method of apportionment of the Special Tax and the proposed issuance of bonds to finance the Facilities and the Incidental Expenses shall be held at 7:00 p.m., or as soon thereafter as practicable, on August 13, 2019, at the City Cultural Center, 183 North Main Street, Lake Elsinore, California. Should the City Council determine to form the District, a special election will be held to authorize the issuance of the bonds and the levy of the special tax in accordance with the procedures contained in Government Code Section 53326. If held, the proposed voting procedure at the election will be a landowner vote with each landowner who is the owner of record of land within the District at the close of the Hearing, or the authorized representative thereof, having one vote for each acre or portion thereof owned within the proposed District. Ballots for the special election may be distributed by mail or by personal service.

Section 8. At the time and place set forth above for the Hearing, the City Council will receive testimony as to whether the proposed Community Facilities District No. 2019-1 shall be established and as to the method of apportionment of the special tax and shall consider:

(a) if an ad valorem property tax is currently being levied on property within proposed Community Facilities District No. 2019-1 for the exclusive purpose of paying principal of or interest on bonds, lease payments or other indebtedness incurred to finance construction of capital facilities; and

(b) if the capital facilities to be financed and constructed by Community Facilities District No. 2019-1 will provide the same services as were provided by the capital facilities mentioned in subsection (a); and

(c) if the City Council makes the findings specified in subsections (a) and (b) above, it will consider appropriate action to determine whether the total annual amount of ad valorem property tax revenue due from parcels within Community Facilities District No. 2019-1, for purposes of paying principal and interest on the debt identified in subsection (a) above, shall not be increased after the date on which Community Facilities District No. 2019-1 is established, or after a later date determined by the City Council with the concurrence of the legislative body which levied the property tax in question.

Section 9. At the time and place set forth above for the Hearing, any interested person, including all persons owning lands or registered to vote within proposed Community Facilities District No. 2019-1, may appear and be heard.

Section 10. Each City officer who is or will be responsible for providing the Facilities within proposed Community Facilities District No. 2019-1, if it is established, is hereby directed to study the proposed District and, at or before the time of the above-mentioned Hearing, file a report with the City Council containing a brief description of the public facilities by type which will in his or her opinion be required to meet adequately the needs of Community Facilities District No. 2019-1 and an estimate of the cost of providing those public facilities, including the cost of environmental evaluations of such facilities and an estimate of the fair and reasonable cost of any Incidental Expenses to be incurred.

Section 11. The District may accept advances of funds or work-in-kind from any source, including, but not limited to, private persons or private entities, for any authorized purpose, including, but not limited to, paying any cost incurred in creating Community Facilities District No. 2019-1. The District may enter into an agreement with the person or entity advancing the funds or work-in-kind, to repay all or a portion of the funds advanced, or to reimburse the person or entity for the value, or cost, whichever is less, of the work-in-kind, as determined by the City Council, with or without interest.

Section 12. The City Clerk is hereby directed to publish a notice (the "Notice") of the Hearing pursuant to Section 6061 of the Government Code in a newspaper of general circulation published in the area of proposed Community Facilities District No. 2019-1. The City Clerk is further directed to mail a copy of the Notice to each of the landowners within the boundaries of the District at least 15 days prior to the Hearing. The Notice shall contain the text or a summary of this Resolution, the time and place of the Hearing, a statement that the testimony of all interested persons or taxpayers will be heard, a description of the protest rights of the registered voters and landowners in the proposed district and a description of the proposed voting procedure for the election required by the Act. Such publication shall be completed at least seven (7) days prior to the date of the Hearing.

Section 13. The reasonably expected maximum principal amount of the bonded indebtedness to be incurred by the District for the Facilities and Incidental Expenses is Eight Million Dollars (\$8,000,000).

Section 14. The form of the Reimbursement Agreement is hereby approved. The Mayor, the City Manager, the Assistant City Manager, or their written designees are hereby authorized and directed to execute and deliver the Reimbursement Agreement in the form on file with the City Clerk with such changes, insertions and omissions as may be approved by the officer or officers executing such agreement, said execution being conclusive evidence of such approval.

Section 15. Except to the extent limited in any bond resolution or trust indenture related to the issuance of bonds, the City Council hereby reserves to itself all rights and powers set forth in Section 53344.1 of the Act (relating to tenders in full or partial payment).

Section 16. This Resolution shall be effective upon its adoption.

Passed and Adopted on this 25th day of June 2019.

Brian Tisdale
Mayor Pro-Tem

Attest:

Mark Mahan
Deputy City Clerk

STATE OF CALIFORNIA)
COUNTY OF RIVERSIDE) ss.
CITY OF LAKE ELSINORE)

I, Grant Yates, Acting City Clerk of the City of Lake Elsinore, California, do hereby certify that Resolution No. 2019-058 was adopted by the City Council of the City of Lake Elsinore, California, at the Regular meeting of June 25, 2019 and that the same was adopted by the following vote:

AYES: Council Members Sheridan and Magee; Mayor Pro-Tem Tisdale
NOES: None
ABSENT: Council Member Johnson and Mayor Manos
ABSTAIN: None

Mark Mahan
Deputy City Clerk

A-1

A-1

ATTACHMENT B

Types of Facilities to Be Financed by Community Facilities District No. 2019-1 of the City of Lake Elsinore

The proposed types of public facilities and expenses to be financed by the District include:

The construction, purchase, modification, expansion, rehabilitation and/or improvement of (i) drainage, library, park, fire, roadway, traffic, administration and community center facilities, marina and animal shelter facilities, and other public facilities of the City, including the foregoing public facilities which are included in the City's fee programs with respect to such facilities and authorized to be financed under the Mello-Roos Community Facilities Act of 1982, as amended (the "City Facilities") and (ii) water and sewer facilities including the acquisition of capacity in the sewer system and/or water system of the Elsinore Valley Municipal Water District which are included in Elsinore Valley Municipal Water District's water and sewer capacity and connection fee programs (the "Water District Facilities" and together, with the City Facilities, the "Facilities"), and all appurtenances and appurtenant work in connection with the foregoing Facilities, including the cost of engineering, planning, designing, materials testing, coordination, construction staking, construction management and supervision for such Facilities, and to finance the incidental expenses to be incurred, including:

- a. The cost of engineering, planning and designing the Facilities;
- b. All costs, including costs of the property owner petitioning to form the District, associated with the creation of the District, the issuance of the bonds, the determination of the amount of special taxes to be levied and costs otherwise incurred in order to carry out the authorized purposes of the District; and
- c. Any other expenses incidental to the construction, acquisition, modification, rehabilitation, completion and inspection of the Facilities.

Capitalized terms used and not defined herein shall have the meaning set forth in the Rate and Method of Apportionment of Special Taxes for the District.

ATTACHMENT C

RATE AND METHOD OF APPORTIONMENT OF SPECIAL TAXES FOR COMMUNITY FACILITIES DISTRICT NO. 2019-1 (WESTLAKE) OF THE CITY OF LAKE ELSINORE

A Special Tax (all capitalized terms are defined in Section A, "Definitions", below) shall be applicable to each Assessor's Parcel of Taxable Property located within the boundaries of the City of Lake Elsinore Community Facilities District No. 2019-1 (Westlake) ("CFD No. 2019-1"). The amount of Special Tax to be levied in each Fiscal Year on an Assessor's Parcel shall be determined by the City Council of the City of Lake Elsinore, acting in its capacity as the legislative body of CFD No. 2019-1, by applying the appropriate Special Tax for Developed Property, Approved Property, Undeveloped Property, and Provisional Undeveloped Property that is not Exempt Property as set forth below. All of the real property, unless exempted by law or by the provisions hereof in Section F, shall be taxed for the purposes, to the extent and in the manner herein provided.

A. DEFINITIONS

The terms hereinafter set forth have the following meanings:

"Acre or Acreage" means the land area of an Assessor's Parcel as shown on an Assessor's Parcel Map, or if the land area is not shown on an Assessor's Parcel Map, the land area shown on the applicable final map, parcel map, condominium plan, or other recorded County parcel map or instrument. The square footage of an Assessor's Parcel is equal to the Acreage multiplied by 43,560.

"Act" means the Mello-Roos Communities Facilities Act of 1982, as amended, being Chapter 2.5 (commencing with Section 53311) of Part 1 of Division 2 of Title 5 of the Government Code of the State of California.

"Administrative Expenses" means the following actual or reasonably estimated costs directly related to the administration of CFD No. 2019-1, including, but not limited to: the costs of computing the Special Taxes and preparing the Special Tax collection schedules (whether by the City or designee thereof or both); the costs of collecting the Special Taxes (whether by the City or otherwise); the costs of remitting Special Taxes to the Trustee; the costs of the Trustee (including legal counsel) in the discharge of the duties required of it under the Indenture; the costs to the City, CFD No. 2019-1 or any designee thereof of complying with arbitrage rebate requirements; the costs to the City, CFD No. 2019-1 or any designee thereof of complying with disclosure requirements of the City, CFD No. 2019-1 or obligated persons associated with applicable federal and state securities laws and the Act; the costs associated with preparing Special Tax disclosure statements and responding to public inquiries regarding the Special Taxes; the costs of the City, CFD No. 2019-1 or any designee thereof related to an appeal of the Special Tax; the costs associated with the release of funds from an escrow account; and the City's annual administration fees and third party expenses. Administration Expenses shall also include amounts estimated by the CFD Administrator or advanced by the City or CFD No. 2019-1 for any other administrative purposes of CFD No. 2019-1, including attorney's fees and other costs related to commencing and pursuing to completion any foreclosure of delinquent Special Taxes.

"Approved Property" means all Assessor's Parcels of Taxable Property: (i) that are included in a Final Map that was recorded prior to the January 1st preceding the Fiscal Year in which the Special Tax is being levied, (ii) and has an assigned Assessor's Parcel Number from the County

shown on an Assessor's Parcel Map for the individual lot included on the Final Map, and (iii) that have not been issued a building permit on or before May 1st preceding the Fiscal Year in which the Special Tax is being levied.

"Assessor's Parcel" means a lot or parcel of land designated on an Assessor's Parcel Map with an assigned Assessor's Parcel Number.

"Assessor's Parcel Map" means an official map of the Assessor of the County designating parcels by Assessor's Parcel Number.

"Assessor's Parcel Number" means that number assigned to an Assessor's Parcel by the County for purposes of identification.

"Assigned Special Tax" means the Special Tax of that name described in Section D below.

"Backup Special Tax" means the Special Tax of that name described in Section D below.

"Boundary Map" means a recorded map of the CFD which indicates the boundaries of the CFD.

"Bonds" means any obligation to repay a sum of money, including obligations in the form of bonds, notes, certificates of participation, long-term leases, loans from government agencies, or loans from banks, other financial institutions, private businesses, or individuals, or long-term contracts, or any refunding thereof, to which Special Tax of CFD No. 2019-1 have been pledged.

"Building Permit" means the first legal document issued by a local agency giving official permission for new construction. For purposes of this definition, "Building Permit" may or may not include any subsequent building permit document(s) authorizing new construction on an Assessor's Parcel that are issued or changed by the City after the first original issuance, as determined by the CFD Administrator as necessary to fairly allocate Special Tax to the Assessor's Parcel, provided that following such determination the Maximum Special Tax that may be levied on all Assessor's Parcels of Taxable Property will be at least 1.1 times maximum annual debt service on all outstanding Bonds plus the estimated annual Administrative Expenses.

"Building Square Footage" or "BSF" means the square footage of assessable internal living space, exclusive of garages or other structures not used as living space, as determined by reference to the Building Permit for such Assessor's Parcel.

"Calendar Year" means the period commencing January 1 of any year and ending the following December 31.

"CFD Administrator" means an official of the City, or designee thereof, responsible for determining the Special Tax Requirement, and providing for the levy and collection of the Special Taxes.

"CFD" or "CFD No. 2019-1" means Community Facilities District No. 2019-1 (Westlake) established by the City under the Act.

"City" means the City of Lake Elsinore.

"City Council" means the City Council of the City of Lake Elsinore, acting as the Legislative Body of CFD No. 2019-1.

"Condominium Plan" means a condominium plan as set forth in the California Civil Code, Section 4285.

"County" means the County of Riverside.

"Developed Property" means all Assessor's Parcels of Taxable Property that: (i) are included in a Final Map that was recorded prior to the January 1st preceding the Fiscal Year in which the Special Tax is being levied, and (ii) has an Assessor's Parcel Number from the County shown on an Assessor's Parcel Map for the individual lot included on the Final Map, and (iii) a Building Permit for new construction was issued on or before May 1st preceding the Fiscal Year in which the Special Tax is being levied.

"Exempt Property" means all Assessor's Parcels designated as being exempt from Special Taxes as provided for in Section F.

"Final Map" means a subdivision of property by recordation of a final map, parcel map, or lot line adjustment, pursuant to the Subdivision Map Act (California Government Code Section 66410 et seq.) or recordation of a Condominium Plan pursuant to California Civil Code Section 1352 that creates individual lots for which Building Permits may be issued without further subdivision.

"Fiscal Year" means the period commencing on July 1st of any year and ending the following June 30th.

"Indenture" means the indenture, fiscal agent agreement, resolution or other instrument pursuant to which Bonds are issued, as modified, amended and/or supplemented from time to time, and any instrument replacing or supplementing the same.

"Land Use Category" means any of the categories listed in Table 1 of Section D.

"Maximum Special Tax" means for each Assessor's Parcel, the maximum Special Tax, determined in accordance with Section D below, that can be levied by CFD No. 2019-1 in any Fiscal Year on such Assessor's Parcel.

"Multifamily Property" means all Assessor's Parcels of Developed Property for which a Building Permit has been issued for the purpose of constructing a building or buildings comprised of attached Residential Units available for rental by the general public, not for sale to an end user, and under common management, as determined by the CFD Administrator.

"Non-Residential Property" or **"NR"** means all Assessor's Parcels of Taxable Property for which a building permit(s) was issued for a non-residential use. The CFD Administrator shall make the determination if an Assessor's Parcel is Non-Residential Property.

"Partial Prepayment Amount" means the amount required to prepay a portion of the Special Tax obligation for an Assessor's Parcel, as described in Section G.2.

"Prepayment Amount" means the amount required to prepay the Special Tax obligation in full for an Assessor's Parcel, as described in Section G.1.

"Proportionately" means for Taxable Property that is (i) Developed Property, that the ratio of the actual Special Tax levy to the Assigned Special Tax is the same for all Assessor's Parcels of Developed Property, (ii) Approved Property, that the ratio of the actual Special Tax levy to the Maximum Special Tax is the same for all Assessor's Parcels of Approved Property, and (iii)

Undeveloped Property, or Provisional Undeveloped Property, that the ratio of the actual Special Tax levy per Acre to the Maximum Special Tax per Acre is the same for all Assessor's Parcels of Undeveloped Property, or Provisional Undeveloped Property, as applicable.

"Provisional Undeveloped Property" means all Assessor's Parcels of Taxable Property that would otherwise be classified as Exempt Property pursuant to the provisions of Section F, but cannot be classified as Exempt Property because to do so would be reduce the Acreage of all Taxable Property below the required minimum Acreage set forth in Sections F.

"Residential Property" means all Assessor's Parcels of Developed Property for which a building permit has been issued for purposes of constructing one or more Residential Units.

"Residential Unit" or "RU" means a residential unit that is used or intended to be used as a domicile by one or more persons, as determined by the CFD Administrator.

"Single Family Residential Property" means all Assessor's Parcels of Residential Property other than Multifamily Property.

"Special Tax" means any of the special taxes authorized to be levied within CFD No. 2019-1 pursuant to the Act to fund the Special Tax Requirement.

"Special Tax Requirement " means the amount required in any Fiscal Year to pay: (i) the debt service or the periodic costs on all outstanding Bonds due in the Calendar Year that commences in such Fiscal Year, (ii) Administrative Expenses, (iii) the costs associated with the release of funds from an escrow account, (iv) any amount required to replenish any reserve funds established in association with the Bonds, (v) an amount equal to any anticipated shortfall due to Special Tax delinquencies, and (vi) for the collection or accumulation of funds for the acquisition or construction of facilities authorized by CFD No. 2019-1 or the payment of debt services on Bonds anticipated to be issued, provided that the inclusion of such amount does not cause an increase in the levy of Special Tax on Approved Property or Undeveloped Property as set forth in Steps Two or Three of Section E., less (vii) any amounts available to pay debt service or other periodic costs on the Bonds pursuant to the Indenture.

"Taxable Property" means all Assessor's Parcels within CFD No. 2019-1, which are not Exempt Property.

"Taxable Unit" means either a Residential Unit or an Acre.

"Tract(s)" means an area of land within a subdivision identified by a particular tract number on a Final Map approved for the subdivision.

"Trustee" means the trustee, fiscal agent, or paying agent under the Indenture.

"Undeveloped Property" means all Assessor's Parcels of Taxable Property which are not Developed Property, Approved Property, Provisional Undeveloped Property.

B. SPECIAL TAX

Commencing Fiscal Year 2020-2021 and for each subsequent Fiscal Year, the City Council shall levy Special Taxes on all Taxable Property, up to the applicable Maximum Special Tax, to fund the Special Tax Requirement.

C. ASSIGNMENT TO LAND USE CATEGORY FOR SPECIAL TAX

Each Fiscal Year, beginning with Fiscal Year 2020-2021, each Assessor's Parcel within CFD No. 2019-1 shall be classified as Taxable Property or Exempt Property. In addition, each Assessor's Parcel of Taxable Property shall be further classified as Developed Property, Approved Property, Undeveloped Property or Provisional Undeveloped Property.

Assessor's Parcels of Developed Property shall further be classified as Residential Property or Non-Residential Property. Each Assessor's Parcel of Residential Property shall further be classified as a Single Family Residential Property, or Multifamily Property. Each Assessor's Parcel of Single Family Residential Property shall be further categorized into Land Use Categories based on its Building Square Footage and assigned to its appropriate Assigned Special Tax rate.

In the event that an Assessor's Parcel for which one or more Building Permits have been issued and the County has not yet assigned final Assessor's Parcel Number(s) to the Residential Unit(s) (in accordance with the Final Map or Condominium Plan) on such Assessor's Parcel, the amount of the Special Tax levy on such Assessor's Parcel for each Fiscal Year shall be determined as follows: (1) the CFD Administrator shall first determine an amount of the Maximum Special Tax levy for such Assessor's Parcel, based on the classification of such Assessor's Parcel as Undeveloped Property; (2) the amount of the Special Tax levy for the Residential Units on such Assessor's Parcel for which Building Permits have been issued shall be determined based on the Developed Property Special Tax rates and shall be taxed as Developed Property in accordance with Step 1 of Section E below; and (3) the amount of the Special Tax levy on the Taxable Property in such Assessor's Parcel not subject to the Special Tax levy in clause (2) shall be equal to: (A) the percentage of the Maximum Special Tax rate levied on all other Undeveloped Property multiplied by the total of the amount determined in clause (1), less the amount determined in clause (2).

D. MAXIMUM SPECIAL TAX

1. Developed Property

The Maximum Special Tax for each Assessor's Parcel of Single Family Residential Property in any Fiscal Year shall be the greater of (i) the Assigned Special Tax or (ii) the Backup Special Tax.

The Maximum Special Tax for each Assessor's Parcel of Non-Residential Property or Multifamily Residential Property shall be the applicable Assigned Special Tax described in Table 1 of Section D.

a. Assigned Special Tax

Each Fiscal Year, each Assessor's Parcel of Single Family Residential Property, Multifamily Property, or Non-Residential Property shall be subject to an Assigned Special Tax. The Assigned Special Tax applicable to an Assessor's Parcel of Developed Property shall be determined pursuant to Table 1 below.

TABLE 1

ASSIGNED SPECIAL TAX FOR DEVELOPED PROPERTY

Land Use Category	Taxable Unit	Building Square Footage	Assigned Special Tax Per Taxable Unit
1. Single Family Residential Property	RU	Less than 1,900 sq. ft	\$2,142.00
2. Single Family Residential Property	RU	1,900 sq. ft to 2,100 sq. ft	\$2,255.00
3. Single Family Residential Property	RU	Greater than 2,100 sq. ft	\$2,332.00
4. Multifamily Property	Acre	N/A	\$34,929.00
5. Non-Residential Property	Acre	N/A	\$34,929.00

On each July 1, commencing July 1, 2021, the Assigned Special Tax rate for Developed Property shall be increased by two percent (2.00%) of the amount in effect in the prior Fiscal Year.

b. Multiple Land Use Categories

In some instances an Assessor's Parcel of Developed Property may contain more than one Land Use Type. The Maximum Special Tax levied on an Assessor's Parcel shall be the sum of the Maximum Special Tax for all Land Use Categories located on the Assessor's Parcel. The CFD Administrator's allocation to each type of property shall be final.

c. Backup Special Tax

The Backup Special Tax for an Assessor's Parcel within a Final Map classified or to be classified as Single Family Property shall be calculated according to the following formula.

$$B = (U \times A) / L$$

The terms above have the following meanings:

B = Backup Special Tax per Assessor's Parcel within the Final Map

U = Maximum Special Tax per Acre of Undeveloped Property per Section D.3 below

A = Acreage of Single Family Residential Property expected to exist in such Final Map at the time of calculation, as determined by the Administrator

L = Number of Residential Units expected to exist in such Final Map at the time of calculation, as determined by the Administrator.

In the event any portion of the Final Map is changed or modified, the Backup Special Tax for all Assessor's Parcels within such changed or modified area shall be \$34,929 per Acre.

In the event any superseding Final Map is recorded as a Final Map within the Boundaries of the CFD, the Backup Special Tax for all Assessor's Parcels within such Final Map shall be \$34,929 per Acre. The Backup Special Tax shall not apply to Multifamily Residential Property, or Non-Residential Property.

On each July 1, commencing July 1, 2021, the Backup Special Tax rate shall be increased by two percent (2.00%) of the amount in effect in the prior Fiscal Year.

2. Approved Property

The Maximum Special Tax for each Assessor's Parcel of Approved Property expected to be classified as Single Family Property shall be the Backup Special Tax computed pursuant to Section D.1.c above.

The Maximum Special Tax for each Assessor's Parcel of Approved Property expected to be classified as Multifamily Residential Property or Non-Residential Property shall be \$34,929 per Acre.

On each July 1, commencing July 1, 2021, the Maximum Special Tax rate for Approved Property shall be increased by two percent (2.00%) of the amount in effect in the prior Fiscal Year.

3. Undeveloped Property and Provisional Undeveloped Property that is not Exempt Property pursuant to the provisions of Section F

The Maximum Special Tax for each Assessor's Parcel of Undeveloped Property and Provisional Undeveloped Property that is not Exempt Property shall be equal to the product of \$34,929 multiplied by the Acreage of such Assessor's Parcel.

On each July 1, commencing July 1, 2021, the Maximum Special Tax rate for Undeveloped and Provisional Undeveloped Property shall be increased by two percent (2.00%) of the amount in effect in the prior Fiscal Year.

E. METHOD OF APPORTIONMENT OF THE SPECIAL TAX

Commencing Fiscal Year 2020-2021 and for each subsequent Fiscal Year, the City Council shall levy Special Taxes on all Taxable Property in accordance with the following steps:

- Step One: The Special Tax shall be levied Proportionately on each Assessor's Parcel of Developed Property at up to 100% of the applicable Assigned Special Tax rates in Table 1 to satisfy the Special Tax Requirement.
- Step Two: If additional moneys are needed to satisfy the Special Tax Requirement after the first step has been completed, the Special Tax shall be levied Proportionately on each Assessor's Parcel of Approved Property at up to 100% of the Maximum Special Tax applicable to each such Assessor's Parcel as needed to satisfy the Special Tax Requirement.
- Step Three: If additional moneys are needed to satisfy the Special Tax Requirement after the first two steps have been completed, the Annual Special Tax shall be levied Proportionately on each Assessor's Parcel of Undeveloped Property up to 100% of the Maximum Special Tax applicable to each such Assessor's Parcel as needed to satisfy the Special Tax Requirement.
- Step Four: If additional moneys are needed to satisfy the Special Tax Requirement after the first three steps have been completed, then the Special Tax levy on each Assessor's Parcel of Developed Property for which the Maximum Special Tax is

the Backup Special Tax shall be increased Proportionately from the Assigned Special Tax up to 100% of the Backup Special Tax as needed to satisfy the Special Tax Requirement.

Step Five: If additional moneys are needed to satisfy the Special Tax Requirement after the first four steps have been completed, the Special Tax shall be levied Proportionately on each Assessor's Parcel of Provisional Undeveloped Property up to 100% of the Maximum Special Tax applicable to each such Assessor's Parcel as needed to satisfy the Special Tax Requirement.

Notwithstanding the above, under no circumstances will the Special Taxes levied in any Fiscal Year against any Assessor's Parcel of Residential Property as a result of a delinquency in the payment of the Special Tax applicable to any other Assessor's Parcel be increased by more than ten percent (10%) above the amount that would have been levied in that Fiscal Year had there never been any such delinquency or default.

F. EXEMPTIONS

The City shall classify as Exempt Property, in the following order of priority, (i) Assessor's Parcels which are owned by, irrevocably offered for dedication, encumbered by or restricted in use by the State of California, Federal or other local governments, including school districts, (ii) Assessor's Parcels which are used as places of worship and are exempt from *ad valorem* property taxes because they are owned by a religious organization, (iii) Assessor's Parcels which are owned by, irrevocably offered for dedication, encumbered by or restricted in use by a homeowners' association, (iv) Assessor's Parcels with public or utility easements making impractical their utilization for other than the purposes set forth in the easement, (v) Assessor's Parcels which are privately owned and are encumbered by or restricted solely for public uses, or (vi) Assessor's Parcels restricted to other types of public uses determined by the City Council, provided that no such classification would reduce the sum of all Taxable Property to less than 11.68 Acres.

Notwithstanding the above, the City Council shall not classify an Assessor's Parcel as Exempt Property if such classification would reduce the sum of all Taxable Property to less than 11.68 Acres. Assessor's Parcels which cannot be classified as Exempt Property because such classification would reduce the Acreage of all Taxable Property to less than 11.68 Acres will be classified as Provisional Undeveloped Property, and will be subject to Special Tax pursuant to Step Five in Section E.

G. PREPAYMENT OF SPECIAL TAX

The following additional definitions apply to this Section G:

"CFD Public Facilities" means \$7,000,000 expressed in 2020 dollars, which shall increase by the Construction Inflation Index on July 1, 2021, and on each July 1 thereafter, or such lower amount (i) determined by the City Council as sufficient to provide the public facilities under the authorized bonding program for CFD No. 2019-1, or (ii) determined by the City Council concurrently with a covenant that it will not issue any more Bonds to be supported by Special Tax levied under this Rate and Method of Apportionment.

"Construction Fund" means an account specifically identified in the Indenture or functionally equivalent to hold funds, which are currently available for expenditure to acquire or construct public facilities eligible to be financed by CFD No. 2019-1.

“Construction Inflation Index” means the annual percentage change in the Engineering News-Record Building Cost Index for the city of Los Angeles, measured as of the Calendar Year which ends in the previous Fiscal Year. In the event this index ceases to be published, the Construction Inflation Index shall be another index as determined by the City that is reasonably comparable to the Engineering News-Record Building Cost Index for the city of Los Angeles.

“Future Facilities Costs” means the CFD Public Facilities minus public facility costs available to be funded through existing construction or escrow accounts funded by the Outstanding Bonds, and minus public facility costs funded by interest earnings on the Construction Fund actually earned prior to the date of prepayment.

“Outstanding Bonds” means all previously issued Bonds issued and secured by the levy of Special Tax which will remain outstanding after the first interest and/or principal payment date following the current Fiscal Year, excluding Bonds to be redeemed at a later date with the proceeds of prior prepayments of Special Tax.

1. Prepayment in Full

The Maximum Special Tax obligation may be prepaid and permanently satisfied for (i) Assessor's Parcels of Developed Property, (ii) Assessor's Parcels of Approved Property or Undeveloped Property for which a Building Permit has been issued, (iii) Approved Property or Undeveloped Property for which a Building Permit has not been issued and (iv) Assessor's Parcels of Public Property or Property Owner's Association Property, or Provisional Undeveloped Property that are not Exempt Property pursuant to Section F. The Maximum Special Tax obligation applicable to an Assessor's Parcel may be fully prepaid and the obligation to pay the Special Tax for such Assessor's Parcel permanently satisfied as described herein; provided that a prepayment may be made only if there are no delinquent Special Taxes with respect to such Assessor's Parcel at the time of prepayment. An owner of an Assessor's Parcel intending to prepay the Maximum Special Tax obligation for such Assessor's Parcel shall provide the CFD Administrator with written notice of intent to prepay, and within 5 business days of receipt of such notice, the CFD Administrator shall notify such owner of the amount of the non-refundable deposit determined to cover the cost to be incurred by the CFD in calculating the Prepayment Amount (as defined below) for the Assessor's Parcel. Within 15 days of receipt of such non-refundable deposit, the CFD Administrator shall notify such owner of the Prepayment Amount for the Assessor's Parcel. Prepayment must be made not less than 60 days prior to the redemption date for any Bonds to be redeemed with the proceeds of such prepaid Special Taxes.

The Prepayment Amount (defined below) shall be calculated as follows (capitalized terms are defined below):

	Bond Redemption Amount
plus	Redemption Premium
plus	Future Facilities Amount
plus	Defeasance Amount
plus	Administrative Fees and Expenses
less	Reserve Fund Credit
Equals:	Prepayment Amount

The Prepayment Amount shall be determined as of the proposed prepayment date as follows:

1. Confirm that no Special Tax delinquencies apply to such Assessor's Parcel.
2. For an Assessor's Parcel of Developed Property, compute the Maximum Special Tax for the Assessor's Parcel. For an Assessor's Parcel of Approved Property or Undeveloped Property for which a Building Permit has been issued, compute the Maximum Special Tax for the Assessor's Parcel as though it was already designated as Developed Property, based upon the Building Permit which has been issued for the Assessor's Parcel. For an Assessor's Parcel of Approved Property or Undeveloped Property for which a Building Permit has not been issued, Public Property, Property Owner's Association Property, or Provisional Undeveloped Property to be prepaid compute the Maximum Special Tax for the Assessor's Parcel.
3. Divide the Maximum Special Tax derived pursuant to paragraph 2 by the total amount of Special Taxes that could be levied at the Maximum Special Tax at build out of all Assessor's Parcels of Taxable Property based on the applicable Maximum Special Tax for Assessor's Parcels of Developed Property not including any Assessor's Parcels for which the Special Tax obligation has been previously prepaid.
4. Multiply the quotient derived pursuant to paragraph 3 by the principal amount of the Outstanding Bonds to determine the amount of Outstanding Bonds to be redeemed with the Prepayment Amount (the "Bond Redemption Amount").
5. Multiply the Bond Redemption Amount by the applicable redemption premium, if any, on the Outstanding Bonds to be redeemed (the "Redemption Premium").
6. Determine the Future Facilities Costs.
7. Multiply the quotient derived pursuant to paragraph 3 by the amount determined pursuant to paragraph 6 to determine the amount of Future Facilities Costs for the Assessor's Parcel (the "Future Facilities Amount").
8. Determine the amount needed to pay interest on the Bond Redemption Amount from the first bond interest and/or principal payment date following the current Fiscal Year until the earliest redemption date for the Outstanding Bonds on which Bonds can be redeemed from Special Tax prepayments.
9. Determine the Special Taxes levied on the Assessor's Parcel in the current Fiscal Year which have not yet been paid.
10. Determine the amount the CFD Administrator reasonably expects to derive from the investment of the Bond Redemption Amount and the Redemption Premium from the date of prepayment until the redemption date for the Outstanding Bonds to be redeemed with the Prepayment Amount.
11. Add the amounts derived pursuant to paragraphs 8 and 9 and subtract the amount derived pursuant to paragraph 10 (the "Defeasance Amount").

12. Verify the administrative fees and expenses of the CFD, including the cost of computation of the Prepayment Amount, the cost to invest the Prepayment Amount, the cost of redeeming the Outstanding Bonds, and the cost of recording notices to evidence the prepayment of the Maximum Special Tax obligation for the Assessor's Parcel and the redemption of Outstanding Bonds (the "Administrative Fees and Expenses").

13. The reserve fund credit (the "Reserve Fund Credit") shall equal the lesser of: (a) the expected reduction in the reserve requirement (as defined in the Indenture), if any, associated with the redemption of Outstanding Bonds as a result of the prepayment, or (b) the amount derived by subtracting the new reserve requirement (as defined in the Indenture) in effect after the redemption of Outstanding Bonds as a result of the prepayment from the balance in the reserve fund on the prepayment date, but in no event shall such amount be less than zero.

14. The Prepayment Amount is equal to the sum of the Bond Redemption Amount, the Redemption Premium, the Future Facilities Amount, the Defeasance Amount and the Administrative Fees and Expenses, less the Reserve Fund Credit.

15. From the Prepayment Amount, the Bond Redemption Amount, the Redemption Premium, and Defeasance Amount shall be deposited into the appropriate fund as established under the Indenture and be used to redeem Outstanding Bonds or make debt service payments. The Future Facilities Amount shall be deposited into the Construction Fund. The Administrative Fees and Expenses shall be retained by the CFD.

The Prepayment Amount may be sufficient to redeem other than a \$5,000 increment of Bonds. In such event, the increment above \$5,000 or an integral multiple thereof will be retained in the appropriate fund established under the Indenture to be used with the next redemption from other Special Tax prepayments of Outstanding Bonds or to make debt service payments.

As a result of the payment of the current Fiscal Year's Special Tax levy as determined pursuant to paragraph 9 above, the CFD Administrator shall remove the current Fiscal Year's Special Tax levy for the Assessor's Parcel from the County tax roll. With respect to any Assessor's Parcel for which the Maximum Special Tax obligation is prepaid, the City Council shall cause a suitable notice to be recorded in compliance with the Act, to indicate the prepayment of Maximum Special Tax obligation and the release of the Special Tax lien for the Assessor's Parcel, and the obligation to pay the Special Tax for such Assessor's Parcel shall cease.

Notwithstanding the foregoing, no Special Tax prepayment shall be allowed unless the amount of Maximum Special Tax that may be levied on all Assessor's Parcels of Taxable Property after the proposed prepayment will be at least 1.1 times maximum annual debt service on the Bonds that will remain outstanding after the prepayment plus the estimated annual Administrative Expenses.

Tenders of Bonds in prepayment of the Maximum Special Tax obligation may be accepted upon the terms and conditions established by the City Council pursuant to the Act. However, the use of Bond tenders shall only be allowed on a case-by-case basis as specifically approved by the City Council.

2. Prepayment in Part

The Maximum Special Tax obligation for an Assessor's Parcel of Developed Property, Approved Property or Undeveloped Property may be partially prepaid. For purposes of determining the partial prepayment amount, the provisions of Section G.1 shall be modified as provided by the following formula:

$$PP = ((P_E - A) \times F) + A$$

These terms have the following meaning:

PP = Partial Prepayment Amount

P_E = the Prepayment Amount calculated according to Section G.1

F = the percent by which the owner of the Assessor's Parcel(s) is partially prepaying the Maximum Special Tax obligation

A = the Administrative Fees and Expenses determined pursuant to Section G.1

The owner of an Assessor's Parcel who desires to partially prepay the Maximum Special Tax obligation for the Assessor's Parcel shall notify the CFD Administrator of (i) such owner's intent to partially prepay the Maximum Special Tax obligation, (ii) the percentage of the Maximum Special Tax obligation such owner wishes to prepay, and (iii) the company or agency that will be acting as the escrow agent, if any. Within 5 days of receipt of such notice, the CFD Administrator shall notify such property owner of the amount of the non-refundable deposit determined to cover the cost to be incurred by the CFD in calculating the amount of a partial prepayment. Within 15 business days of receipt of such non-refundable deposit, the CFD Administrator shall notify such owner of the amount of the Partial Prepayment Amount for the Assessor's Parcel. A Partial Prepayment Amount must be made not less than 60 days prior to the redemption date for the Outstanding Bonds to be redeemed with the proceeds of the Partial Prepayment Amount.

With respect to any Assessor's Parcel for which the Maximum Special Tax obligation is partially prepaid, the CFD Administrator shall (i) distribute the Partial Prepayment Amount as provided in Paragraph 15 of Section G.1, and (ii) indicate in the records of the CFD that there has been a Partial Prepayment for the Assessor's Parcel and that a portion of the Maximum Special Tax obligation equal to the remaining percentage $(1.00 - F)$ of the Maximum Special Tax obligation will continue to be levied on the Assessor's Parcel pursuant to Section E.

H. TERMINATION OF SPECIAL TAX

For each Fiscal Year that any Bonds are outstanding the Special Tax shall be levied on all Assessor's Parcels subject to the Special Tax. The Special Tax shall cease not later than the 2059-2060 Fiscal Year, however, Special Tax will cease to be levied in an earlier Fiscal Year if the CFD Administrator has determined (i) that all the required interest and principal payments on the CFD No. 2019-1 Bonds have been paid; (ii) all authorized facilities of CFD No. 2019-1 have been acquired and all reimbursements to the developer have been paid, (iii) no delinquent Special Tax remain uncollected and (iv) all other obligations of CFD No. 2019-1 have been satisfied.

I. MANNER OF COLLECTION

The Special Tax shall be collected in the same manner and at the same time as ordinary *ad valorem* property taxes, provided, however, that CFD No. 2019-1 may collect Special Taxes at a different time or in a different manner if necessary to meet its financial obligations, and may

covenant to foreclose and may actually foreclose on delinquent Assessor's Parcels as permitted by the Act.

J. APPEALS OF SPECIAL TAXES

Any taxpayer may file a written appeal of the Special Taxes on his/her Assessor's Parcel(s) with the CFD Administrator, provided that the appellant is current in his/her payments of Special Taxes. During pendency of an appeal, all Special Taxes previously levied must be paid on or before the payment date established when the levy was made. The appeal must specify the reasons why the appellant claims the Special Tax is in error. The CFD Administrator shall review the appeal, meet with the appellant if the CFD Administrator deems necessary, and advise the appellant of its determination. If the CFD Administrator agrees with the appellant, the CFD Administrator shall grant a credit to eliminate or reduce future Special Taxes on the appellant's Assessor's Parcel(s). No refunds of previously paid Special Taxes shall be made.

The CFD Administrator shall interpret this Rate and Method of Apportionment and make determinations relative to the annual levy and administration of the Special Taxes and any taxpayer who appeals, as herein specified.



SPICER CONSULTING
GROUP